

定频一拖二 (三) 室外机爆炸图零配件中英文对照表

Exploded View Parts for Model: M20A-21HRN1 220-240V, 50Hz; Outdoor Unit

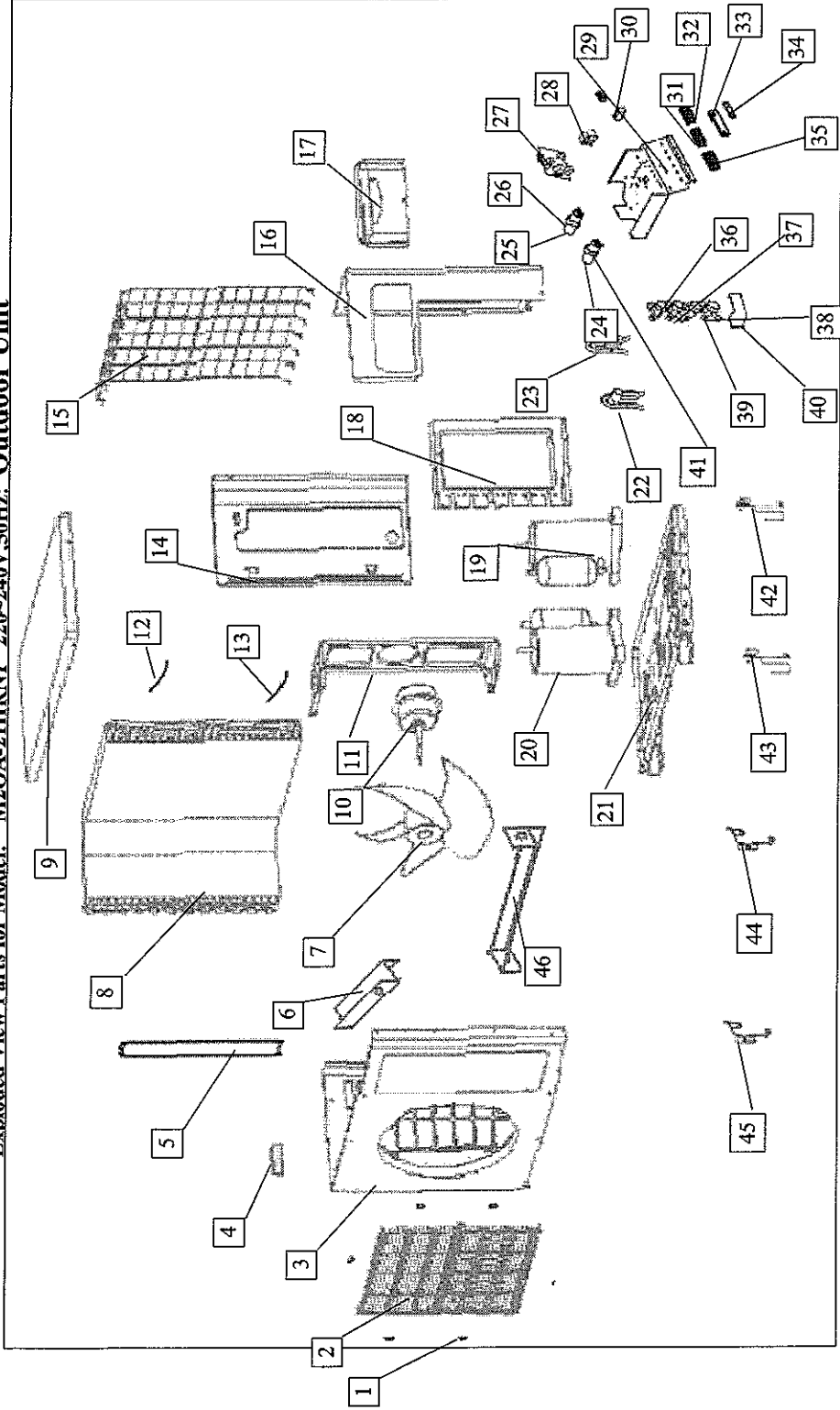

序号	零部件名称		数量	物料编码		价格	备注
	中文	Part Name		SALE CODE	BOM CODE		
1	前网卡子	Clamp for front net	6	10112121801	2113511801	0.10	
2	出风网罩	Front net	1	10718111822	2125024203	2.10	
3	前壳板	Front clapboard	1	53818121807	2125024227	14.70	
4	小把手	Small Handle	1	10109121802	2113500006	0.10	
5	前壳板加强板	Strengthen board for front clapboard	1	10718111801	2125024213	0.90	
6	电机支架加强条 II	Strengthen board for motor holder II	1	53818121809	2125024229	0.20	
7	轴流风叶	Propeller fan	1	53818121810	2110030014	0.00	
8	冷凝器部件	Condenser	1	53821121801	2155029068	81.10	
9	顶盖	Cover	1	10718111803	2125024204	6.80	
10	风扇电机	Fan motor	1	53818121811	2240042009	38.70	
11	电机支架	Holder for fan motor	1	10718111828	2125024224	3.40	
12	室外温度传感器	Outdoor temp sensor	1	10909121819	2244532622	1.00	
13	管温传感器 II 部零件	Condenser temp sensor	1	10121121816	2244050002	1.20	
14	隔板	Separating board	1	53821121802	2125024233	4.90	
15	进风网罩	Rear net	1	10718111806	2125024210	1.50	
16	右后侧板	Rear right clapboard	1	10718121811	2125024214	5.90	
17	大把手	Big handle	1	10718121821	2115029004	0.70	
18	阀安装板	Installation plate for valves	1	10718111817	2125024209	2.40	
19	B机压缩机	Compressor B	1	12809111802	2140061970	69.00	PA108X1C-4FT
20	A机压缩机	Compressor A	1	12812111805	2140061990	86.00	PA145X2C-4FT
21	底盘部件	Chassis	1	53818121814	2125024232	18.20	
22	A机四通阀	4-Ways valve for unit A	1	53821121803	2165029394	18.80	
23	B机四通阀	4-Ways valve for unit B	1	53818121816	2165029373	17.30	
24	A(32)机压机电容	Compressor capacitor for unit A	1	30324313020	2240100602	4.70	35UF/440-450V
25	B(26)机压机电容	Compressor capacitor for unit B	1	10309121820	2240100402	3.40	25UF/440-450V
26	电容卡	Capacitor clamp	1	10109121822	2120010005	0.10	
27	室外主控板组件	Main control board	1	10718121810	2135029600	41.50	

2135029600

28	变压器	Transformer	1	10718121808	2230090015	3.60	
29	电器安装板	Installation board for E-parts	1	10718121820	2125024222	1.40	
30	风机电容	Fan motor capacitor	1	10718121804	2240110404	1.00	4uF/450V
31	四位接线座	Wire joint, 4p	1	10718121807	2230145003	0.60	
32	两位接线座	Wire joint for multiplexer	1	10718121806	2230145017	0.30	
33	接线底板	Washer for wire joint	1	10112121817	2113500004	0.10	
34	出线压片	Clamp for wiring	1	10112121816	2121990001	0.10	
35	六位接线座	Wire joint, 6p	1	10718121805	2230145030	0.90	
36	A机高压阀	Liquid pipe valve for unit A	1	53818121804	2160074091	2.60	
37	A机低压阀	Gas pipe valve for unit A	1	53648122805	2160072193	4.60	
38	B机高压阀	Liquid pipe valve for unit B	1	53818121804	2160074091	2.60	
39	B机低压阀	Gas pipe valve for unit B	1	53818121805	2160072091	3.90	
40	接水盘	Water collector	1	10718111816	2113560000	0.20	
41	电容卡	Capacitor clamp	1	31116313015	2120010009	0.10	
42	A机四通阀组件	Gas valve assy, unit A	1	53821121803	2165029394	18.80	
43	B机四通阀组件	Gas valve assy, unit B	1	53818121816	2165029373	17.30	
44	A机高压阀组件	Liquid valve assy, unit A	1	53821121804	2165029392	4.80	
45	B机高压阀组件	Liquid valve assy, unit B	1	53818121818	2165029365	5.20	
46	电机支架加强条 I	Strengthen board for motor holder I	1	53818121808	2125024228	0.20	