



# WIND 10-90 RANGE

## CENTRIFUGAL FAN - COILS

# ***LENNOX***<sup>®</sup>



## ACCESSORIES

## CENTRIFUGAL FAN COIL UNITS

## INDEX

Single-row auxiliary coil	3
ON/OFF valve kit with 2 fittings	4
ON/OFF valve kit with 3 fittings	6
Heating elements	8
Condensate pump	8
Auxiliary condensate collecting tray (vertical version)	9
Auxiliary condensate collecting tray (orizontal version)	9
External air intake air lock	10
Pair of enamelled feet	11
Air intake socle	11
Pre-enamelled white sheet metal panel (version 7)	12
Pre-enamelled white sheet metal panel (versions 2/3)	12
White lacquered wood panel (version 7)	13
Outlet unions with circular fittings	14
Intlet unions with circular fittings and air filter	14
Straight outlet fitting	15
Outlet elbow	15
Intake elbow	16
Outlet louvres and intake grille (with air filter)	16
Telescopic extension for straight fittings and elbows	17
Example of use of fittings and grilles/louvers	17
Enamelled rear panel (for standard housing)	18
Enamelled rear panel (for housing with socle)	18
Bottom panel without grille	19
Bottom panel with grille and filter	19

## SINGLE ROW AUXILIARY COIL

This is used in 4-pipe systems, which comprise 2 independent water circuits: one for cooling and the other for heating. In this case the auxiliary coil is used for heating.

The constructional characteristics are similar to those of the main coil with brass inlet/outlet headers and air valves. The fittings have a diameter of 1/2" with internal GAS thread.

The fan coil model in which the auxiliary coil is to be installed must be specified at the time of ordering.

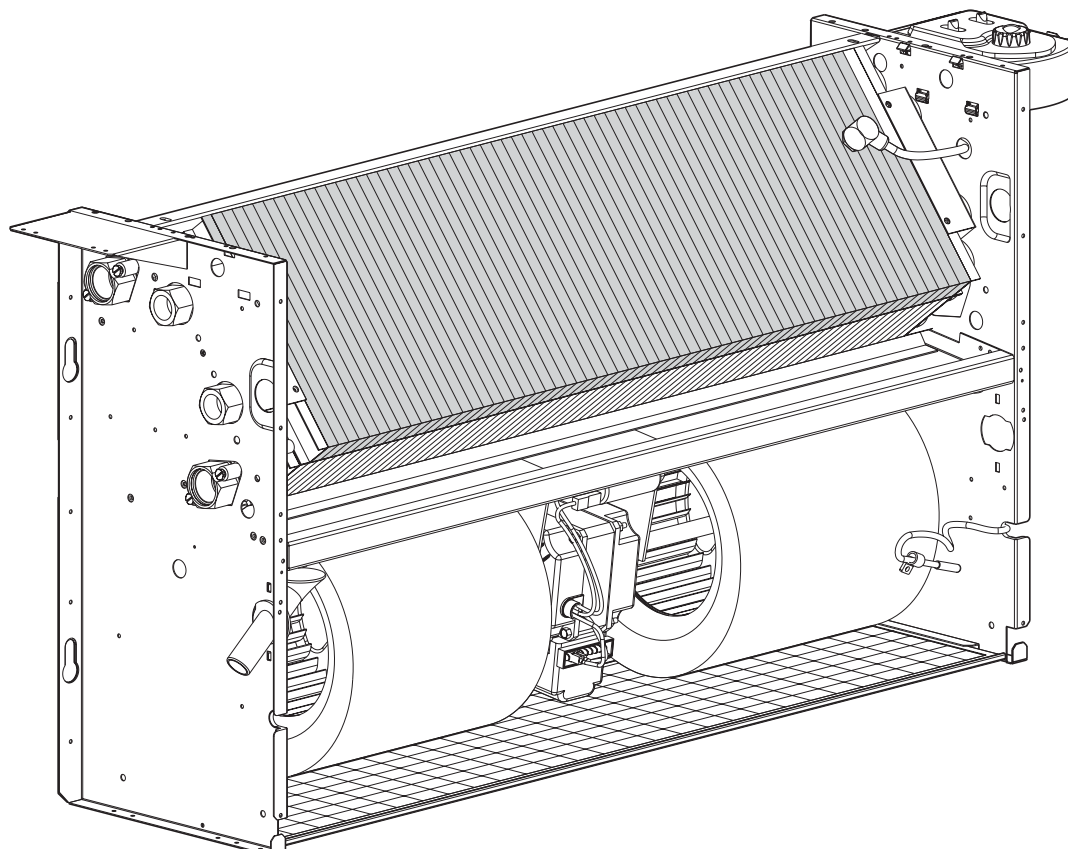

Model		WIND10	WIND20	WIND30	WIND40	WIND50	WIND60	WIND70	WIND80	WIND90
Heating capacity	W	1.261	1.894	2.726	2.887	3.489	4.131	5.044	6.193	7.665
	kCal/h	1.087	1.633	2.350	2.489	3.008	3.561	4.348	5.339	6.608
Water flow	l/h	109	163	235	249	301	356	435	534	661
	l/s	0,030	0,405	0,065	0,069	0,084	0,176	0,121	0,148	0,184
Water pressure loss	kPa	0,3	0,7	1,7	2,0	3,4	4,2	7,5	13,9	21,7
	m C.A.	0,03	0,07	0,17	0,20	0,34	0,42	0,75	1,39	2,17

Technica data:

- maximum fan speed
- indicated water flow rate
- inflowing water temperature at 70°C
- heat drop of 10°C
- inflowing air temperature at 20°C

## CENTRIFUGAL FAN COIL UNITS

## ON/OFF 2-WAY VALVE KIT

On/Off 2-way solenoid valves with bypass (2 fittings) are available.

The valve body is in brass; an on/off electrothermal actuator (power supply 230Vac) controls the membrane. When there is no power supply the valve is closed.

The electrothermal actuator is silent during operation.

The kit comprises valve body, electrothermal actuator, flared copper pipes, ring nuts and gaskets for fixing to the fan coil.

The valve kit is already installed on the fan coil complete with the water and electrical connections necessary for operation.

The fan coil model and the coil (standard or auxiliary) to which the kit refers must be specified at the time of ordering.

## Technical data:

Electrical power supply	230 V/50-60 Hz
Input	3 VA
Breakaway starting current	0,3 A (230 V)
Working current	0,013 A (230 V)
Max travel	4 mm
Pressure	90 N
Opening time	3 min
Max. differential pressure (with valve Ø 1/2")	1,5 bar
Max. differential pressure (with valve Ø 3/4")	0,5 bar
Working room temperature	50°C
Protection rating (vertical inst.)	IP43
Protection rating (horizontal inst.)	IP40
Insulation	Double or reinforced
Connecting cable	Two pin Ø 0.5 mm <sup>2</sup>
Size	68,5x50x50

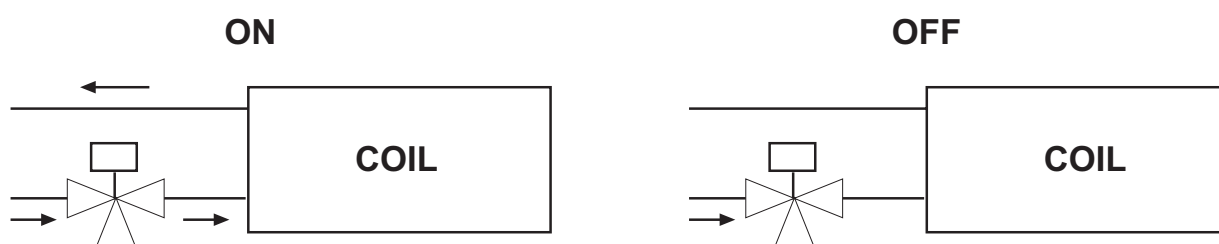

## ON/OFF 2-WAY VALVE KIT

### 2-WAY SOLENOID VALVE WITH 2 FITTINGS

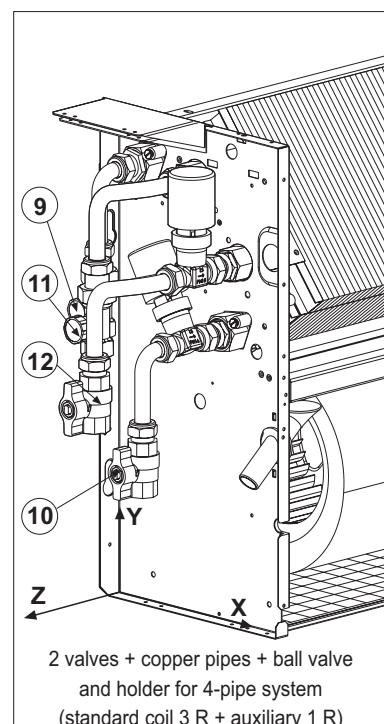
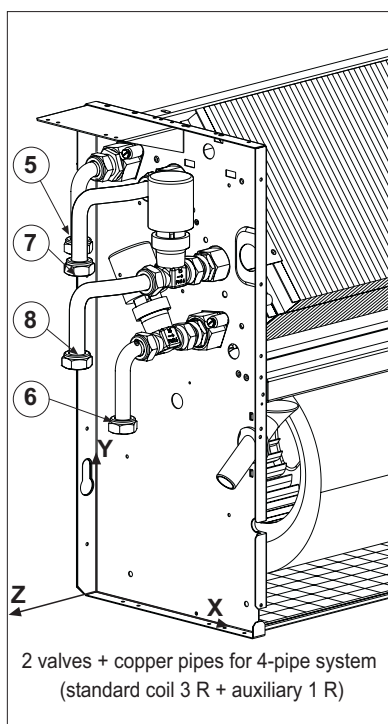
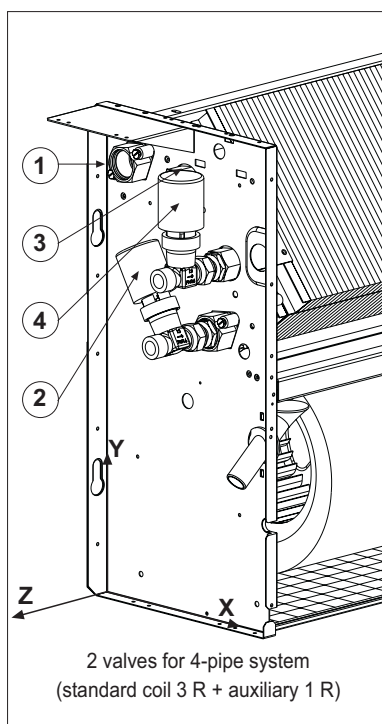
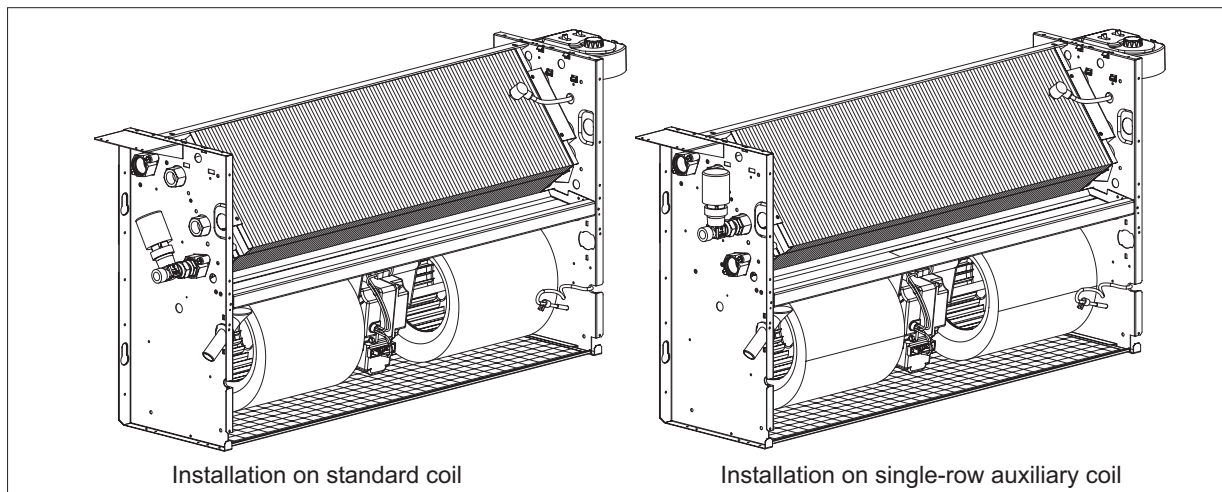

COIL	Ref.	WIND 10-60 range			WIND 70-90 range			Fittings
		X	Y	Z	X	Y	Z	
STANDARD	1	40	10	18	39	411	25	3/4" F
	2	143	277	90	145	273	110	1/2" F
AUXILIARY - 1R	3	113	405	10	103	404	25	1/2" F
	4	155	333	83	155	373	95	1/2" F
STANDARD	5	40	343	55	38	483	55	1/2" F
	6	145	213	120	150	235	132	1/2" F
AUXILIARY - 1R	7	30	315	50	30	400	62	1/2" F
	8	80	245	105	77	277	122	1/2" F
STANDARD	9	40	260	55	38	388	55	3/4" F
	10	145	152	120	150	175	132	3/4" F
AUXILIARY - 1R	11	30	233	50	30	305	62	3/4" F
	12	80	185	105	77	220	122	3/4" F

F = female gas fittings

## CENTRIFUGAL FAN COIL UNITS

## ON/OFF 3-WAY VALVE KIT

On/Off 3-way solenoid valves with bypass (4 fittings) are available.

The valve body is in brass; an on/off electrothermal actuator (power supply 230Vac) controls the membrane. When there is no power supply the valve is closed.

The electrothermal actuator is silent during operation.

The kit comprises valve body, electrothermal actuator, flared copper pipes, ring nuts and gaskets for fixing to the fan coil.

The valve kit is already installed on the fan coil complete with the water and electrical connections necessary for operation.

The fan coil model and the coil (standard or auxiliary) to which the kit refers must be specified at the time of ordering.

## Technical data:

Electrical power supply	230 V/50-60 Hz
Input	3 VA
Breakaway starting current	0,3 A (230 V)
Working current	0,013 A (230 V)
Max travel	4 mm
Pressure	90 N
Opening time	3 min
Max. differential pressure (with valve Ø 1/2")	1,5 bar
Max. differential pressure (with valve Ø 3/4")	0,5 bar
Working room temperature	50°C
Protection rating (vertical inst.)	IP43
Protection rating (horizontal inst.)	IP40
Insulation	Double or reinforced
Connecting cable	Two pin Ø 0.5 mm <sup>2</sup>
Size	68,5x50x50

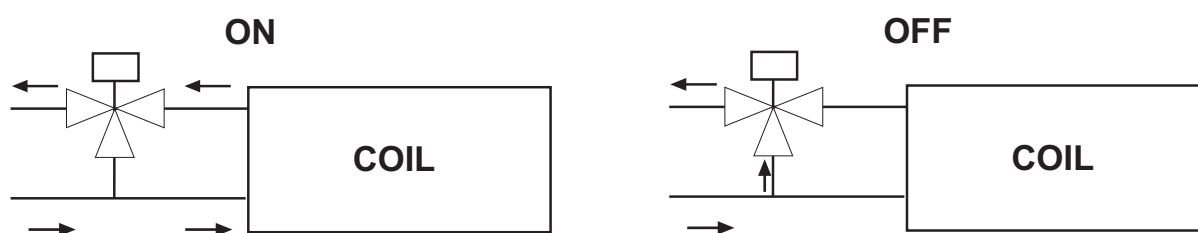

## ON/OFF 3-WAY VALVE KIT

### 3-WAY SOLENOID VALVE WITH 4 FITTINGS

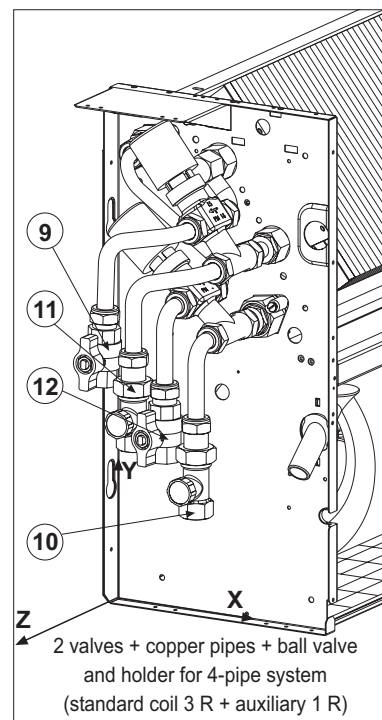
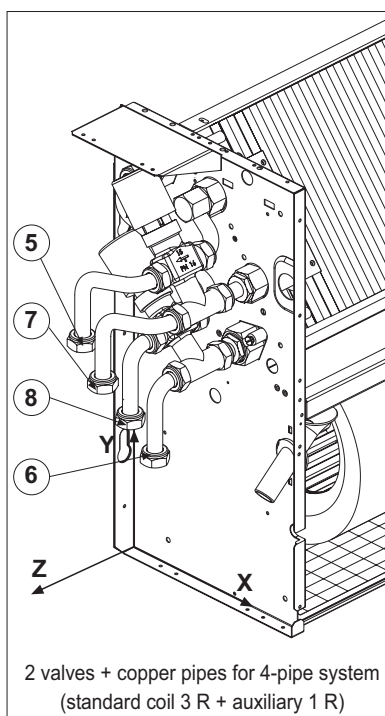
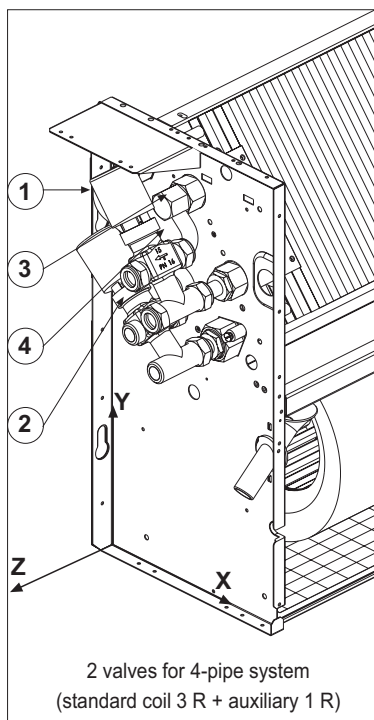
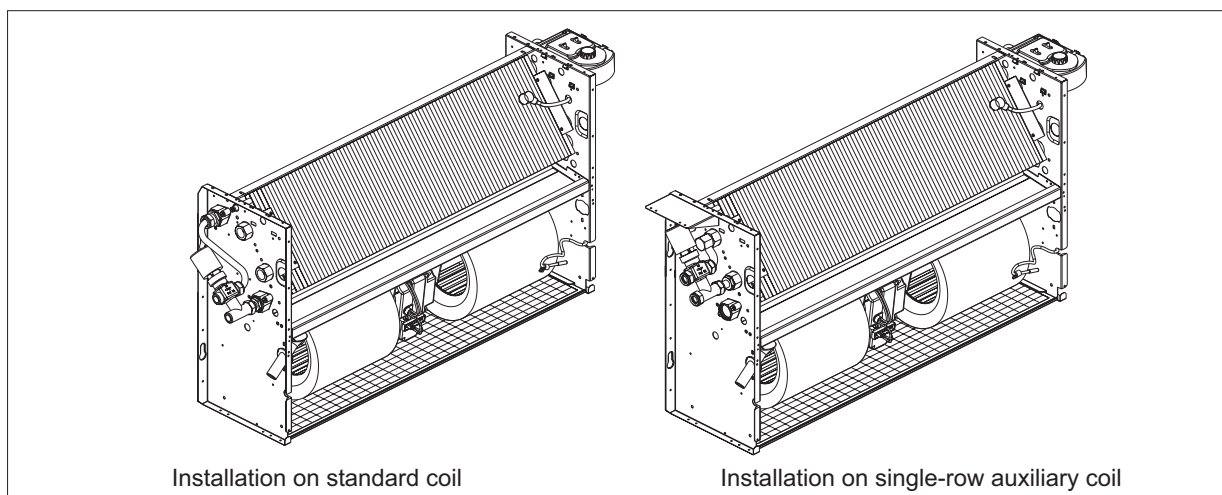

COIL	Ref.	WIND 10-60 range			WIND 70-90 range			Fittings
		X	Y	Z	X	Y	Z	
STANDARD	1	115	295	90	110	293	110	3/4" F
	2	147	270	90	145	273	110	1/2" F
AUXILIARY - 1R	3	130	370	92	120	398	115	1/2" F
	4	155	335	92	153	375	115	1/2" F
STANDARD	5	115	225	110	110	255	133	1/2" F
	6	147	200	110	145	235	133	1/2" F
AUXILIARY - 1R	7	57	278	120	40	302	145	1/2" F
	8	85	250	120	82	277	145	1/2" F
STANDARD	9	115	165	110	110	162	133	3/4" F
	10	147	122	110	145	178	133	3/4" F
AUXILIARY - 1R	11	55	220	117	40	205	145	3/4" F
	12	87	167	117	82	220	145	3/4" F

F= attacchi gas femmina



## CENTRIFUGAL FAN COIL UNITS

## HEATING ELEMENT

The heating element kit is used during heating to integrate the heating power of the main coil or alternatively as the only heating element.

The power of the heating element depends on the size of the fan coil on which it is mounted; the larger the fan coil the greater the power of the heating element.

The kit comprises the heating element with aluminium heatsink, safety thermostat, control relay and relative wiring and is already built into the fan coil complete with all electrical connections.

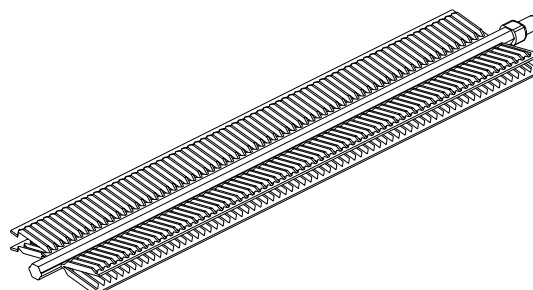
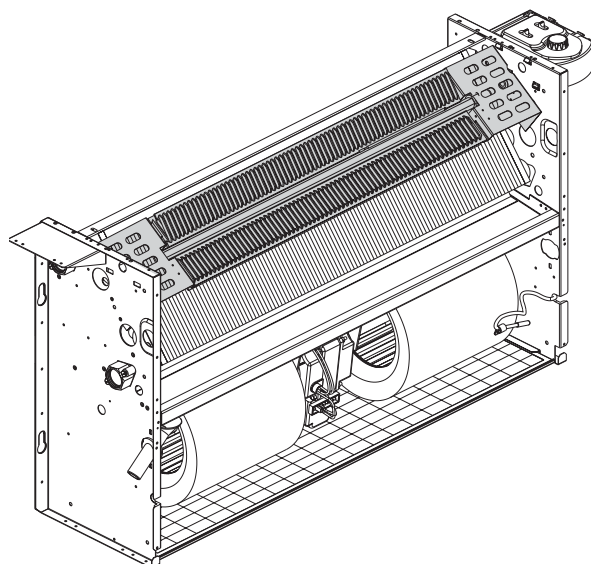

**SUPPLY VOLTAGE:**  
**230 V/1/50Hz**

MODEL		WIND10*	WIND20	WIND30	WIND40	WIND50	WIND60	WIND70	WIND80	WIND90
Heating capacity	W	-								
	W	-								
Input	W $\pm$ 10%	-								
	W $\pm$ 10%	-								
Working current	A	-								
	A	-								
Max. working temperature	°C	-	350	350	350	350	350	350	350	350
Dist. between slits	mm	-	2,1	2,5	2,1	2,5	2,1	2,1	2,1	2,1

\* not available

## POMPA SCARICO CONDENZA

Viene utilizzata per eliminare l'acqua di condensa che si raccoglie nella bacinella, nel caso in cui l'installazione non consenta lo scarico per caduta. La pompa è completa di filtro per bloccare le impurità, galleggiante con contatto di attivazione, tubo aspirante, corpo pompa completo di elettronica di controllo e protezione contro il surriscaldamento, cablaggi.

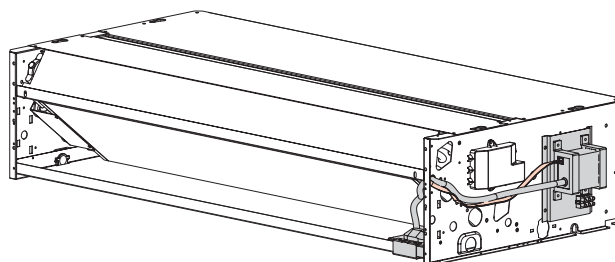

Portata max.	10l/h $\pm$ 10%
Mandata max.	6m CA $\pm$ 10%
Aspirazione max.	2,5 m CA $\pm$ 10%
Tensione	230 V ~ 50/60Hz - 110 V ~ 50/60Hz
Potenza	18 W
Protezione termica	70°C (riarmo automatico)
Contenitore auto-estinguente	UL94 V0
Cavo di collegamento	HO5 VVF 3G 0,75 mm <sup>2</sup>

## ACCESSORIES



## AUXILIARY CONDENSATE COLLECTING TRAY - vertical version

The painted, galvanised sheet metal auxiliary tray is used to collect condensate from the valves and the pipes connecting to the unit. It is suitable for vertically mounted fan coils.

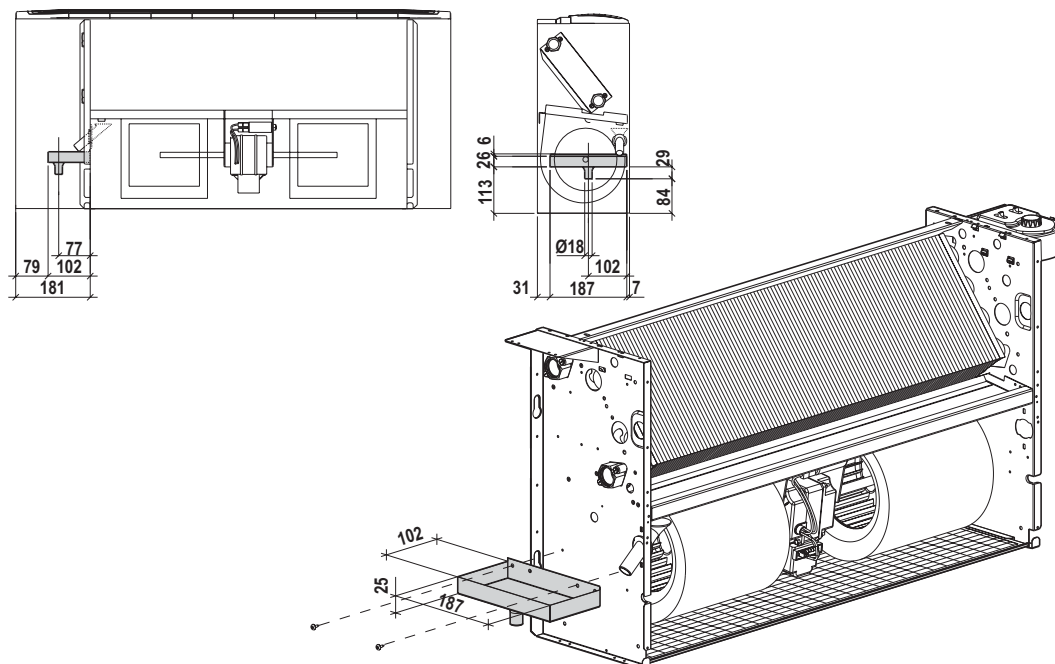

## AUXILIARY CONDENSATE COLLECTING TRAY - horizontal version

The painted, galvanised sheet metal auxiliary tray is used to collect condensate from the valves and the pipes connecting to the unit. It is suitable for horizontally mounted fan coils.

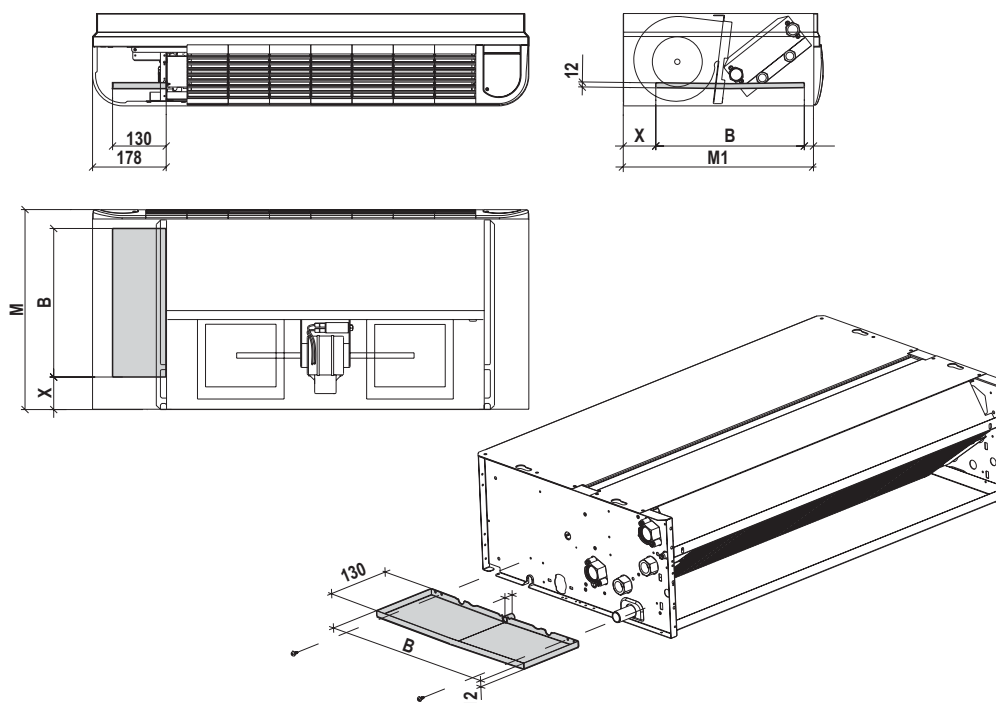

MODEL			WIND10	WIND20	WIND30	WIND40	WIND50	WIND60	WIND70	WIND80	WIND90
M	mm		480	480	480	480	480	480	581	581	581
M1	mm		460	460	460	460	460	460	565	565	565
B	mm		360	360	360	360	360	360	320	320	320
X	mm		79	79	79	79	79	79	270	270	270

## CENTRIFUGAL FAN COIL UNITS

## EXTERNAL AIR INTAKE AIR LOCK

To ensure sufficient air in the rooms a continuous change of air is necessary. This is done by introducing a percentage of air from outdoors.

The external air intake air lock is used for this purpose. It is installed at the bottom of the fan coil on the intake line. It may be installed on both the wall-mounted vertical and the ceiling-mounted horizontal versions. For correct installation, the fan coil must have a pair of feet or intake plinths.

The air lock is made in galvanised sheet metal and may be provided with manual control (placed in line with the same) or with electric servo control.

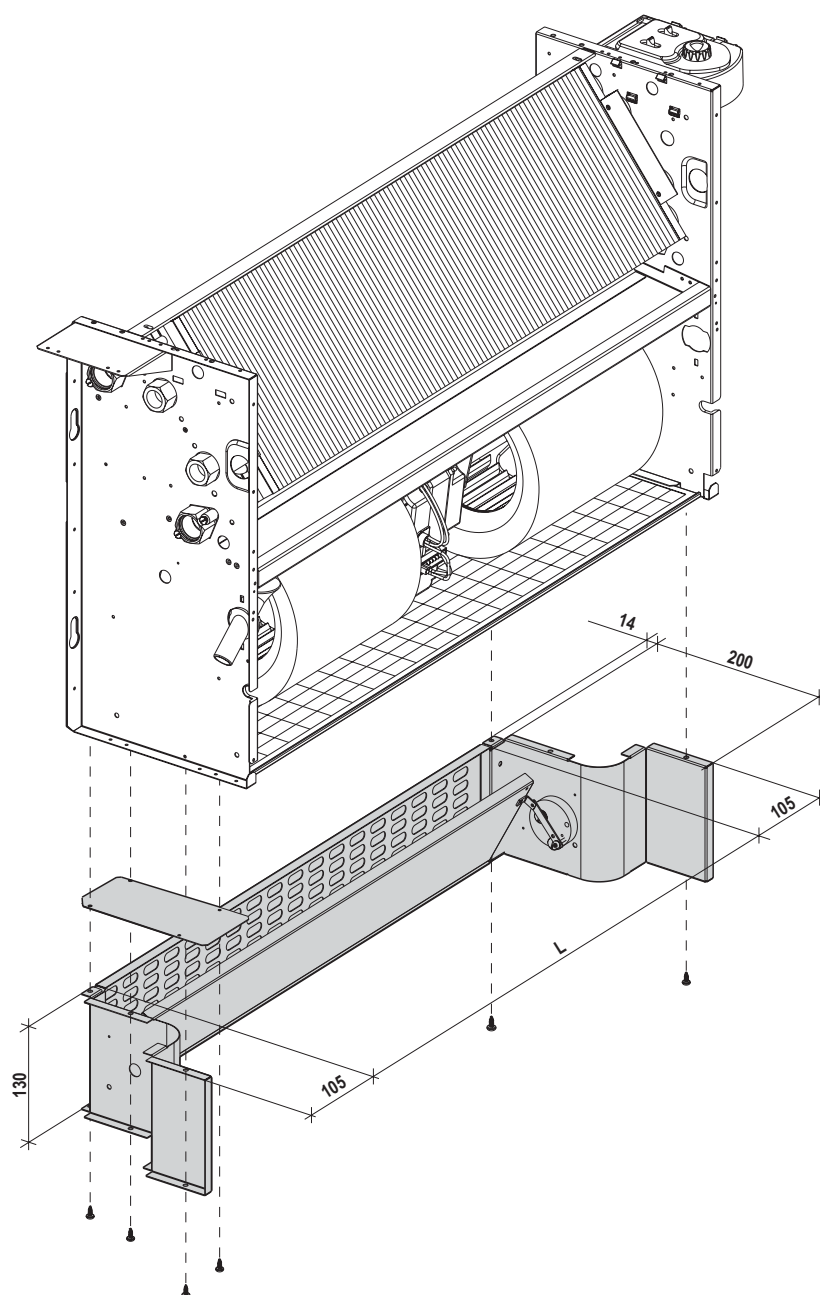

MODEL	WIND10	WIND20	WIND30	WIND40	WIND50	WIND60	WIND70	WIND80	WIND90
Width L	255	455	655	655	855	855	855	1.055	1.055
	mm								
Air flow	Internal		External		Total				
%	78		22		100				

## ACCESSORIES

## PAIR OF ENAMELLED FEET

Pair of feet in pre-enamelled sheet metal designed to support the fan coil for floor-standing installation.

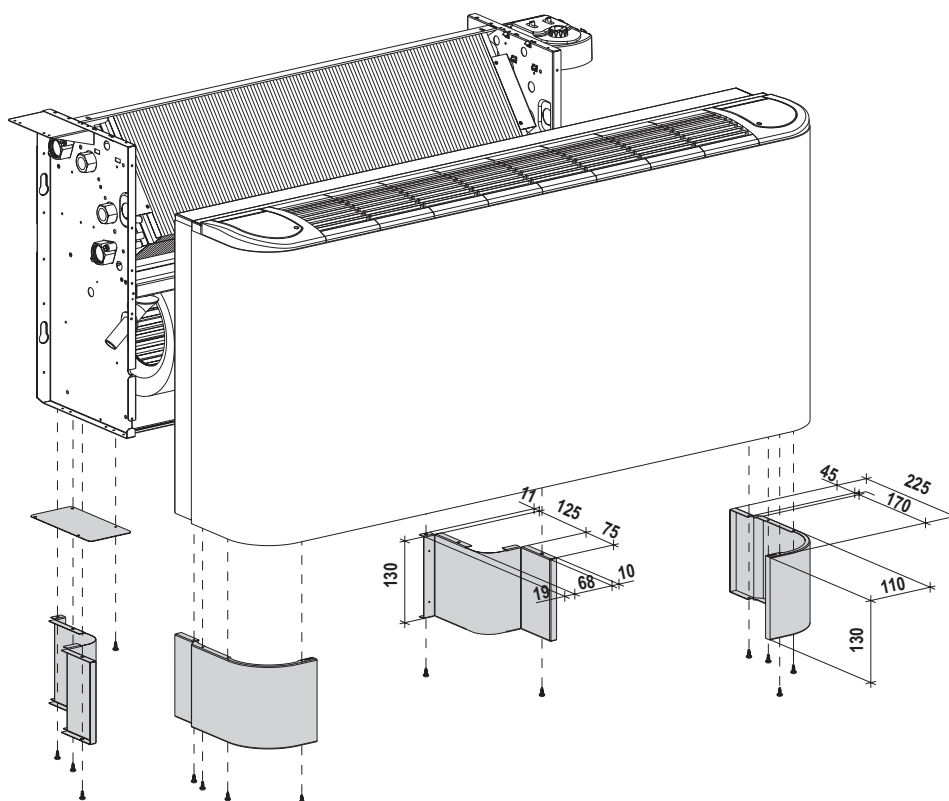

## AIR INTAKE SOCLE

This is used together with the pair of feet to conceal the lower part of the appliance. The air intake grille and filter is integrated into the socle, which may also be used in the ceiling-mounted versions.

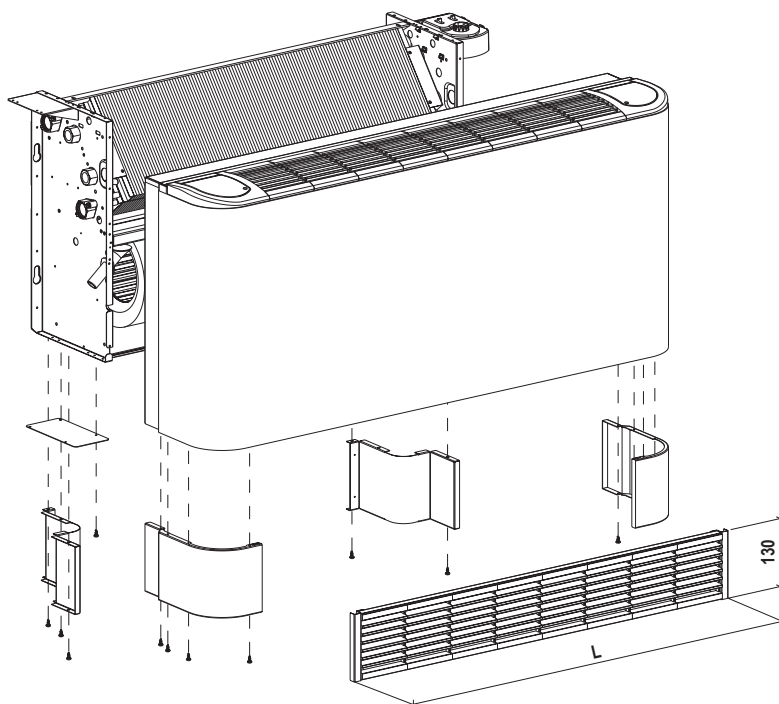

MODEL	WIND10	WIND20	WIND30	WIND40	WIND50	WIND60	WIND70	WIND80	WIND90
Width L	330	530	730	730	930	930	930	1.130	1.130

## CENTRIFUGAL FAN COIL UNITS

## PRE-ENAMELLED WHITE SHEET METAL PANEL

Built-in fan coils (wall or ceiling mounted) should be concealed for aesthetic and safety purposes. The sheet metal panel does this by fully closing off the recess housing the appliance. The panel is made in pre-enamelled white sheet metal. It is fixed directly onto the fan coil with hidden self-tapping screws. The air intake grille (with filter) and outlet louvres are inserted in the panel. By turning the outlet louvres the air flow may be directed upwards or downwards. There are two types of panels for each size of fan coil: version 7 (fan coil with front outlet) and version 2 and 3 (fan coil with vertical or horizontal outlet complete with 90° elbow).

Panel for version 7

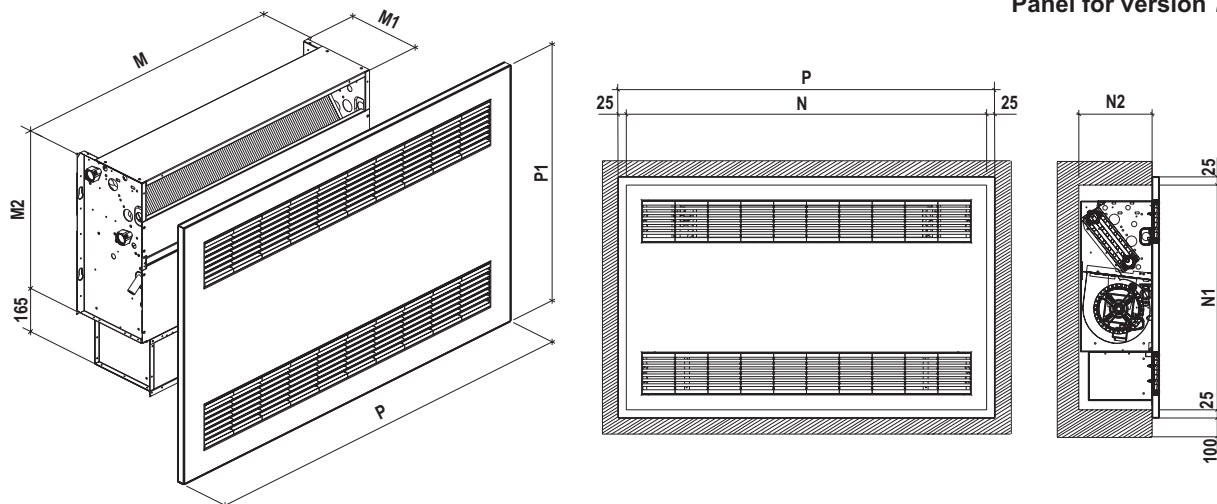

Panel for version 3

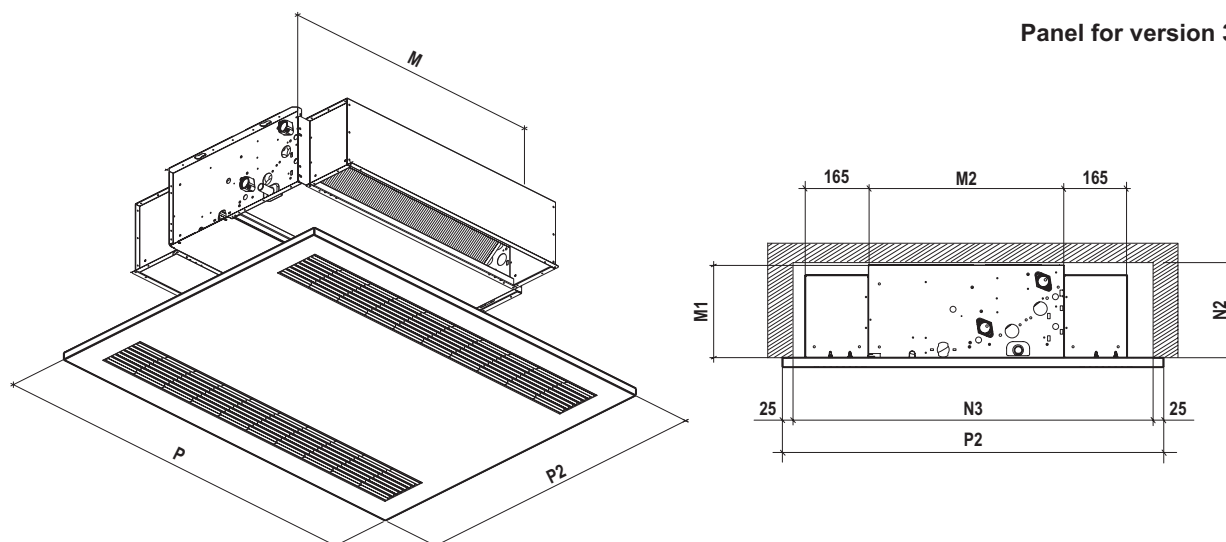

MODEL			WIND10	WIND20	WIND30	WIND40	WIND50	WIND60	WIND70	WIND80	WIND90
N	mm		700	900	1.100	1.100	1.300	1.300	1.300	1.500	1.500
N1	mm		685	685	685	685	685	685	790	790	790
N2	mm		225	225	225	225	225	225	225	225	225
N3	mm		845	845	845	845	845	845	950	950	950
P	mm		750	950	1.150	1.150	1.350	1.350	1.350	1.550	1.550
P1	mm		735	735	735	735	735	735	840	840	840
P2	mm		895	895	895	895	895	895	1.000	1.000	1.000
M	mm		420	620	820	820	1.020	1.020	1.020	1.220	1.220
M1	mm		220	220	220	220	220	220	220	220	220
M2	mm		460	460	460	460	460	460	565	565	565



N....N2 = **MINIMUM** recess size  
P, P1 = Panel length  
M.... M3 = Fan coil size

## ACCESSORIES

## WHITE LACQUERED WOOD PANEL

An elegant white lacquered wood panel for installation in environments where the design is particularly important. The wood panel allows the fan coil to be fully concealed by closing off the recess in which it is installed. It is fixed directly onto the fan coil by hidden self-tapping screws. The air intake grille (with filter) and outlet louvres are inserted in the panel. By turning the outlet louvres the airflow may be directed upwards or downwards. The panels are only available for version 7 (fan coil with front outlet).

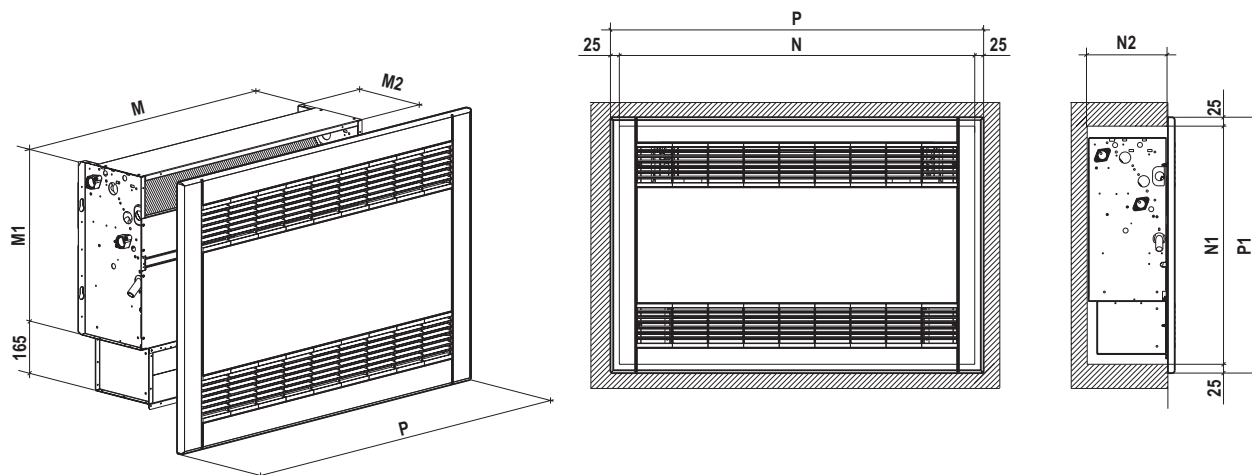

MODEL			WIND10	WIND20	WIND30	WIND40	WIND50	WIND60	WIND70	WIND80	WIND90
N	mm	*	800	1.000	1.000	1.200	1.200	1.200	1.400	1.400	
N1	mm	*	670	670	670	670	670	775	775	775	
N2	mm	*	227	227	227	227	227	227	227	227	
P	mm	*	850	1.050	1.050	1.250	1.250	1.250	1.450	1.450	
P1	mm	*	720	720	720	720	720	825	825	825	
M	mm	*	620	820	820	1.020	1.020	1.020	1.220	1.220	
M1	mm	*	460	460	460	460	460	565	565	565	
M2	mm	*	220	220	220	220	220	220	220	220	



N....N2 = **MINIMUM** recess size  
P, P1 = Panel length  
M.... M3 = Fan coil size

## CENTRIFUGAL FAN COIL UNITS

## OUTLET UNIONS WITH CIRCULAR FITTINGS

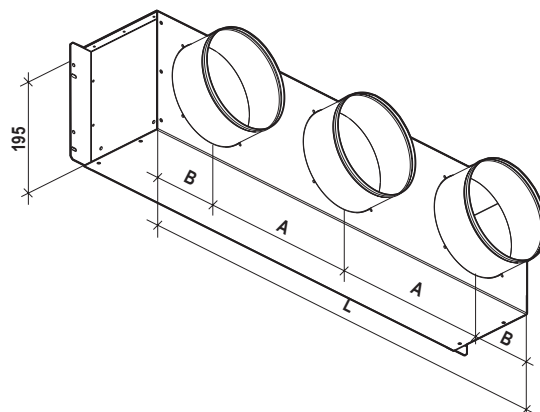

## INLET UNIONS WITH CIRCULAR FITTINGS AND AIR FILTER

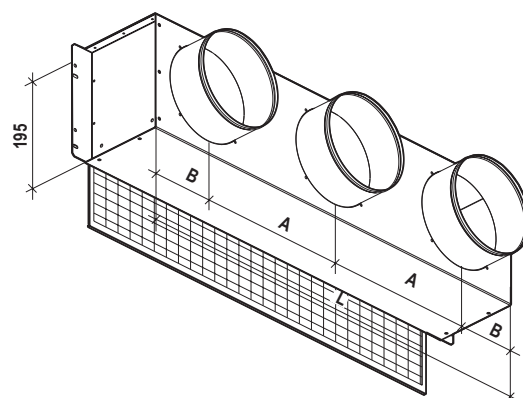

MODEL		WIND10	WIND20	WIND30	WIND40	WIND50	WIND60	WIND70	WIND80	WIND90
A	mm	-	327	263,5	263,5	242,5	242,5	242,5	309	309
B	mm	171,5	108	108	108	108	108	108	108	108
L	mm	343	543	743	743	943	943	943	1.143	1.143
No. x Ø	mm	1x Ø160	2x Ø160	3x Ø160	3x Ø160	4x Ø160	4x Ø160	4x Ø160	4x Ø160	4x Ø160

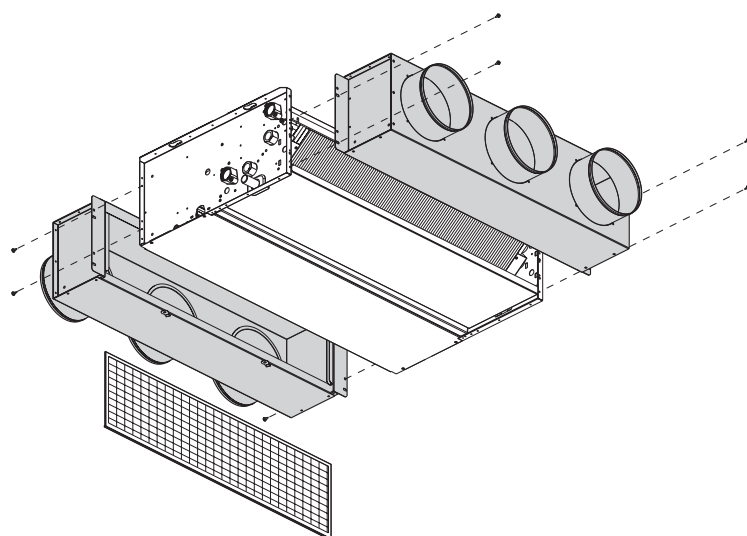

The painted, galvanised sheet metal plenum with circular fittings is used to convey the air with vertical or horizontal built-in fan coil installation. The air filter may be easily drawn out for inspection or cleaning.

## STRAIGHT OUTLET FITTING

In galvanised sheet metal, it is used to convey air with vertical or horizontal built-in fan coil installation.

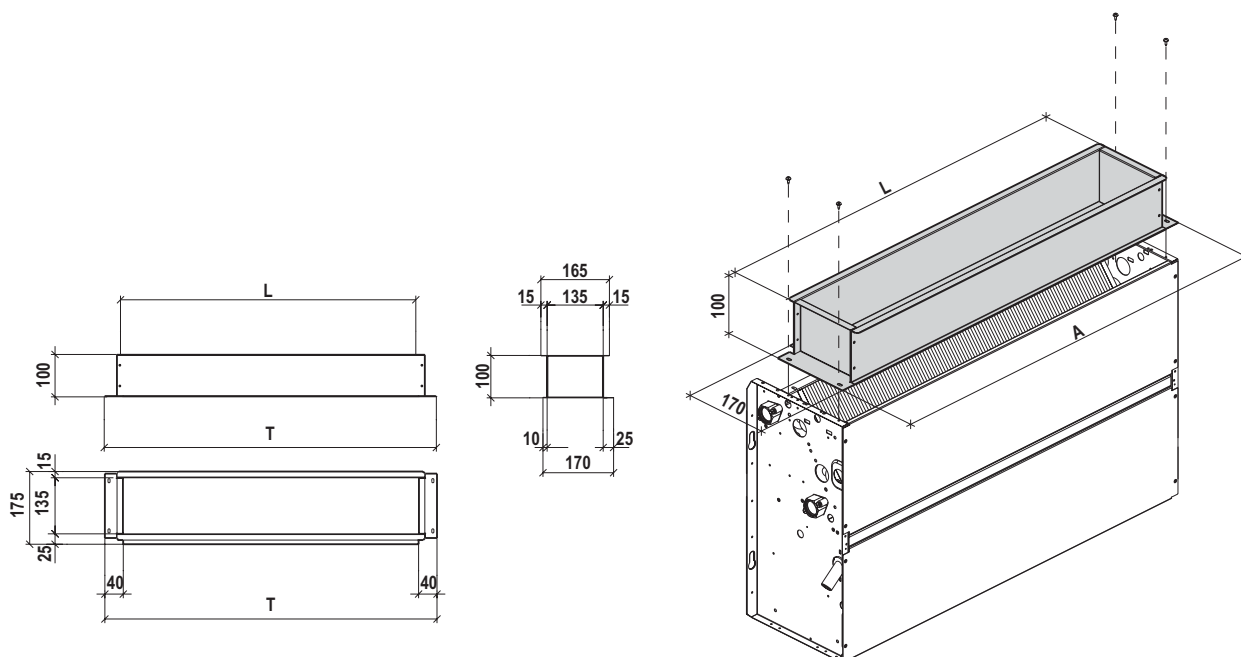

## 90° OUTLET ELBOW

In galvanised sheet metal, it is used to convey air with vertical or horizontal built-in fan coil installation.

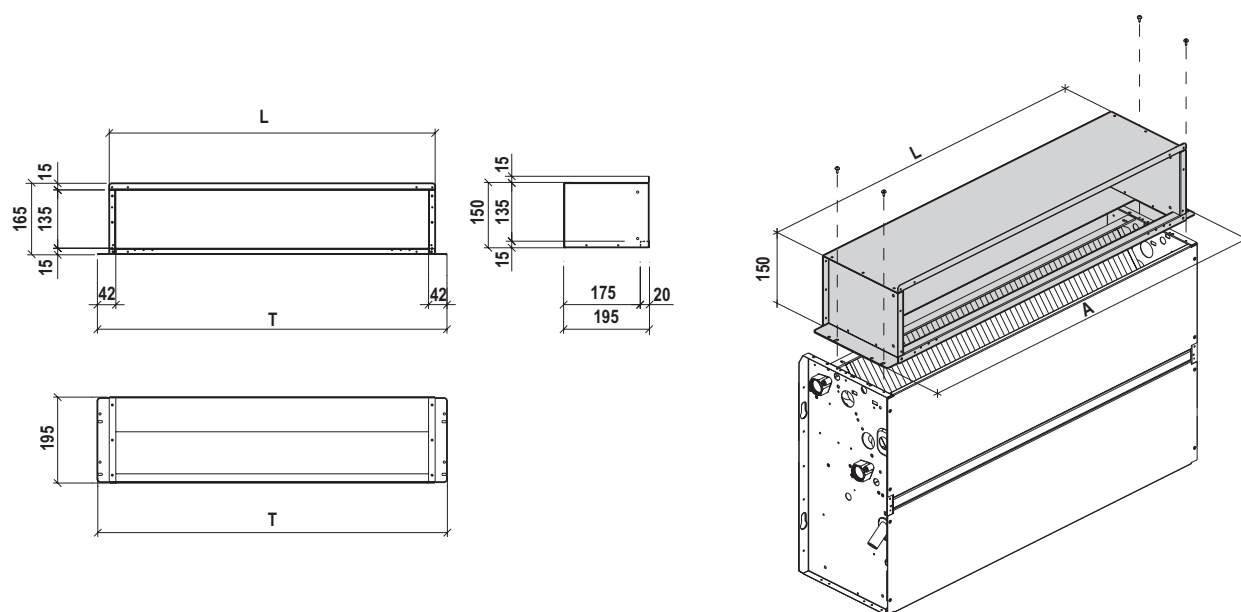

MODEL		WIND10	WIND20	WIND30	WIND40	WIND50	WIND60	WIND70	WIND80	WIND90
L	mm	343	543	743	743	943	943	943	1.143	1.143
T	mm	397	597	797	797	997	997	997	1.197	1.197



## CENTRIFUGAL FAN COIL UNITS

## INTAKE ELBOW

In galvanised sheet metal, it is used to convey air with vertical or horizontal built-in fan coil installation.

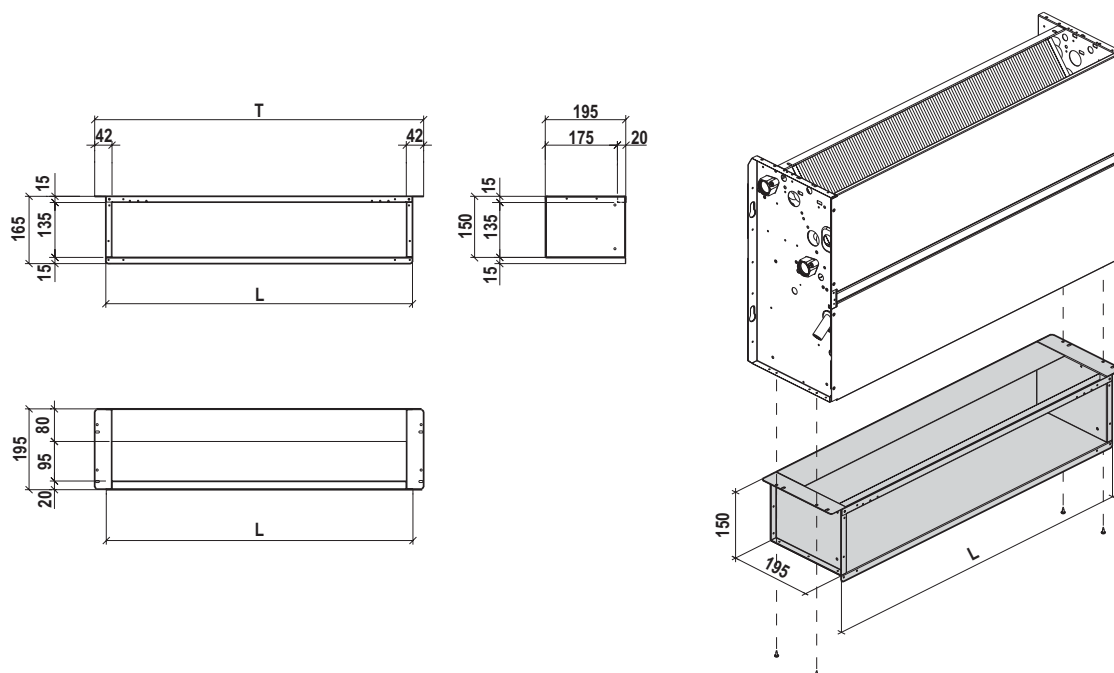

MODEL			WIND10	WIND20	WIND30	WIND40	WIND50	WIND60	WIND70	WIND80	WIND90
L	mm		343	543	743	743	943	943	943	1.143	1.143
T	mm		397	597	797	797	997	997	997	1.197	1.197

## OUTLET LOUVRES and INTAKE GRILLE (with air filter)

In high-strength enamelled sheet metal, they are complete with fixed louvres in thermoplastic material for the distribution/intake of air.

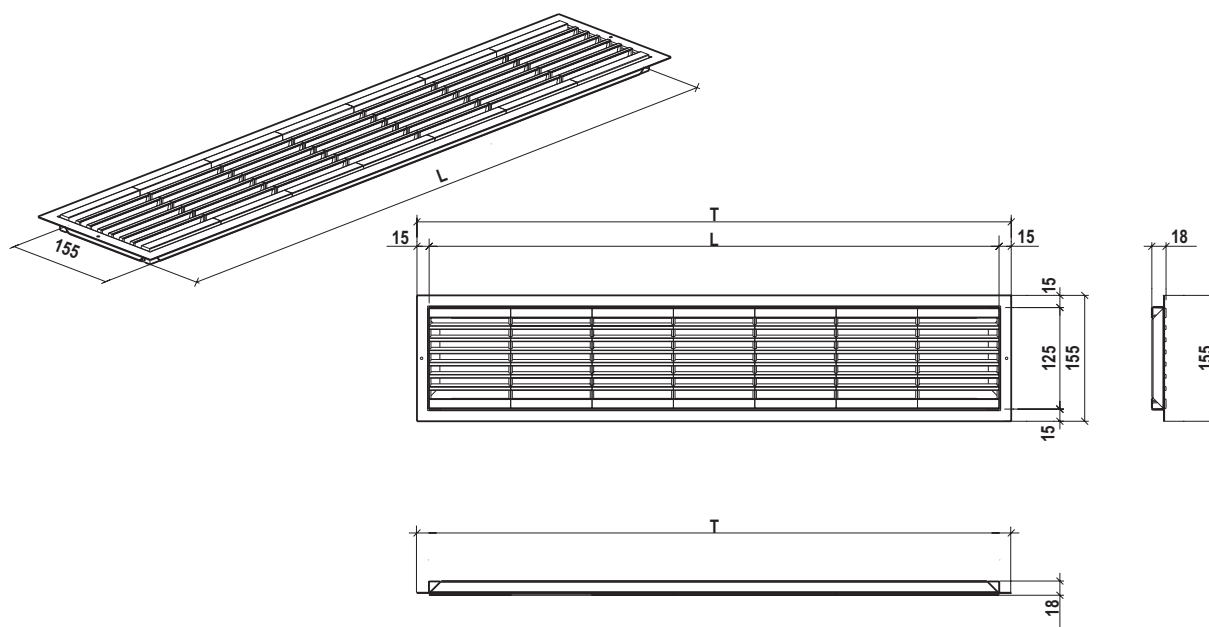

MODEL			WIND10	WIND20	WIND30	WIND40	WIND50	WIND60	WIND70	WIND80	WIND90
L1	mm		306	506	706	706	906	906	906	1.106	1.106
T1	mm		330	530	730	730	930	930	930	1.130	1.130

## ACCESSORIES

## TELESCOPIC EXTENSION FOR STRAIGHT FITTINGS AND ELBOWS

In galvanised sheet metal, it is used as support for the straight fittings or elbows both on the air intake and outlet.

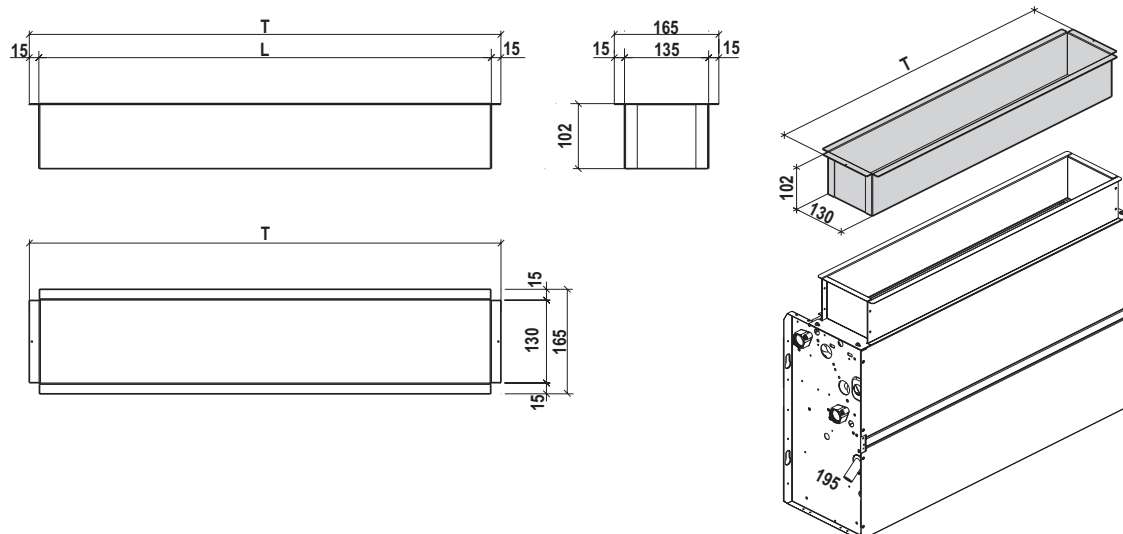

MODEL		WIND10	WIND20	WIND30	WIND40	WIND50	WIND60	WIND70	WIND80	WIND90
L1	mm	306	506	706	706	906	906	906	1.106	1.106
T1	mm	310	510	710	710	910	910	910	1.110	1.110

## EXAMPLE OF USE OF FITTINGS AND GRILLES/LOUVRES

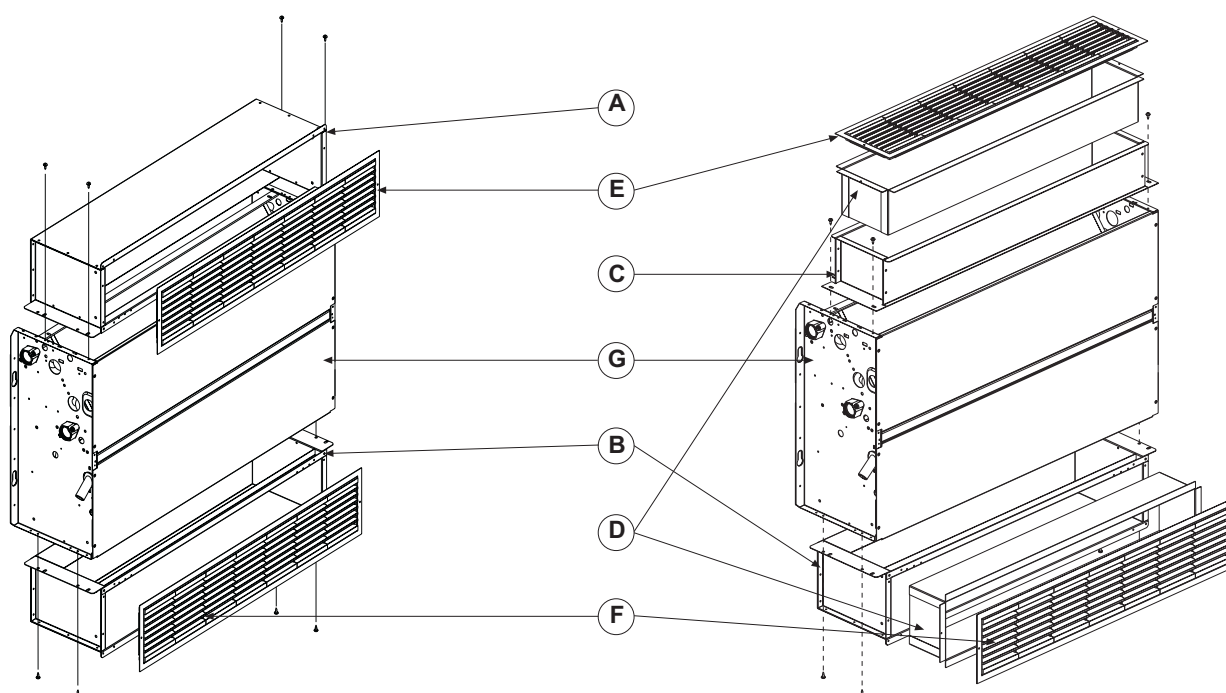

- A: Elbow on outlet
- B: Elbow on intake
- C: Straight fitting on outlet
- D: Telescopic extension for straight fittings and elbows
- E: Outlet louvres (without air filter)
- F: Intake grille (with air filter)
- G: Fan coil

## CENTRIFUGAL FAN COIL UNITS

**ENAMELLED REAR PANEL (FOR STANDARD HOUSING)**

Painted sheet metal panel for closing the rear part of the fan coil when exposed (for standard housing).

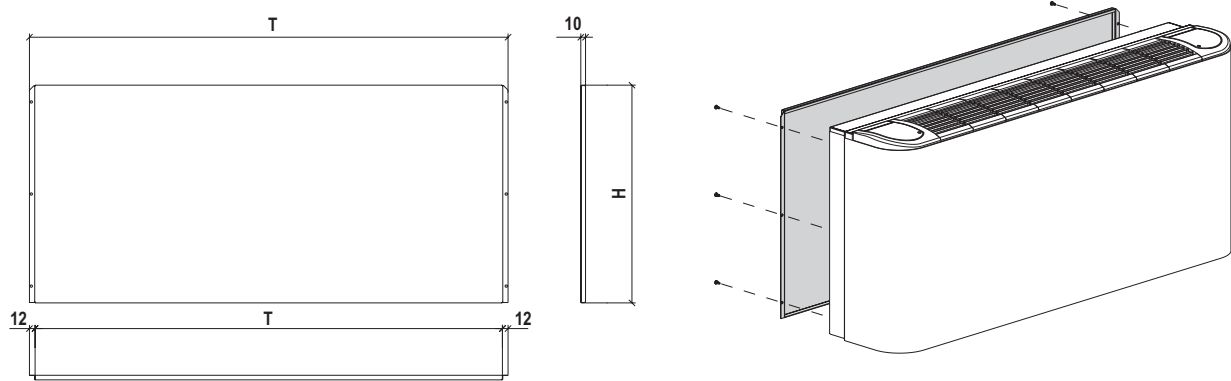
**ENAMELLED REAR PANEL (FOR HOUSING WITH SOCLE)**

Painted sheet metal panel for closing the rear part of the fan coil when exposed (for housing with socle).

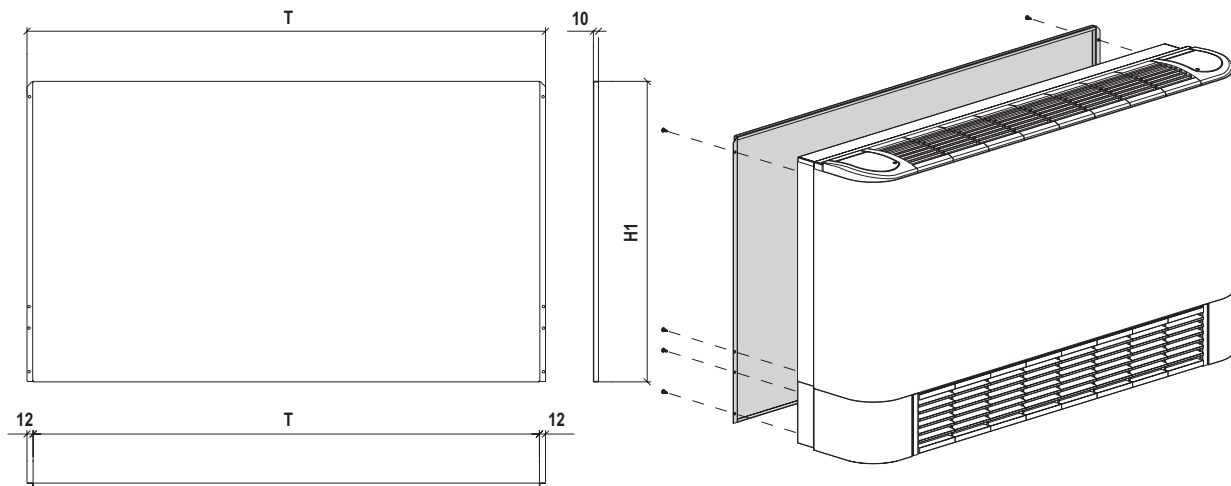

MODEL			WIND10	WIND20	WIND30	WIND40	WIND50	WIND60	WIND70	WIND80	WIND90
T	mm		637	837	1.037	1.037	1.237	1.237	1.237	1.437	1.437
L	mm		613	813	1.013	1.013	1.213	1.213	1.213	1.413	1.413
H	mm		588	588	588	588	588	588	693	693	693
H1	mm		601	601	601	601	601	601	706	706	706

## ACCESSORIES

## BOTTOM PANEL WITHOUT GRILLE

Painted sheet metal panel for closing the bottom part of the fan coil when exposed (for versions with front intake).

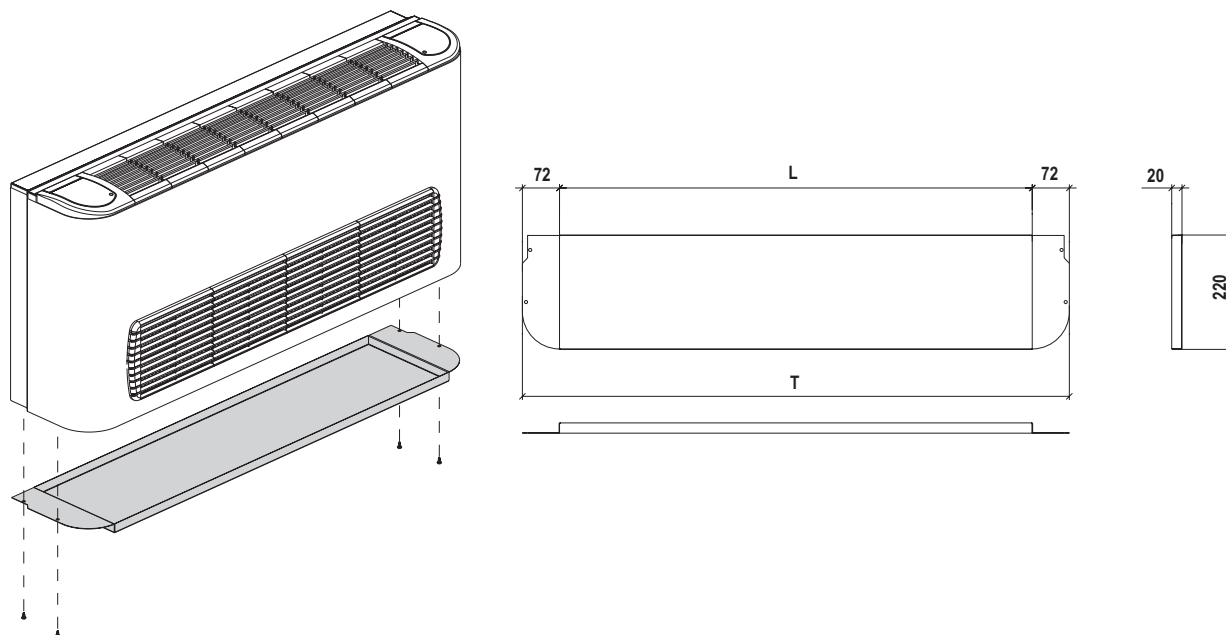

## BOTTOM PANEL WITH GRILLE AND FILTER

Painted sheet metal panel for closing the bottom part of the fan coil when exposed (for versions with bottom intake).

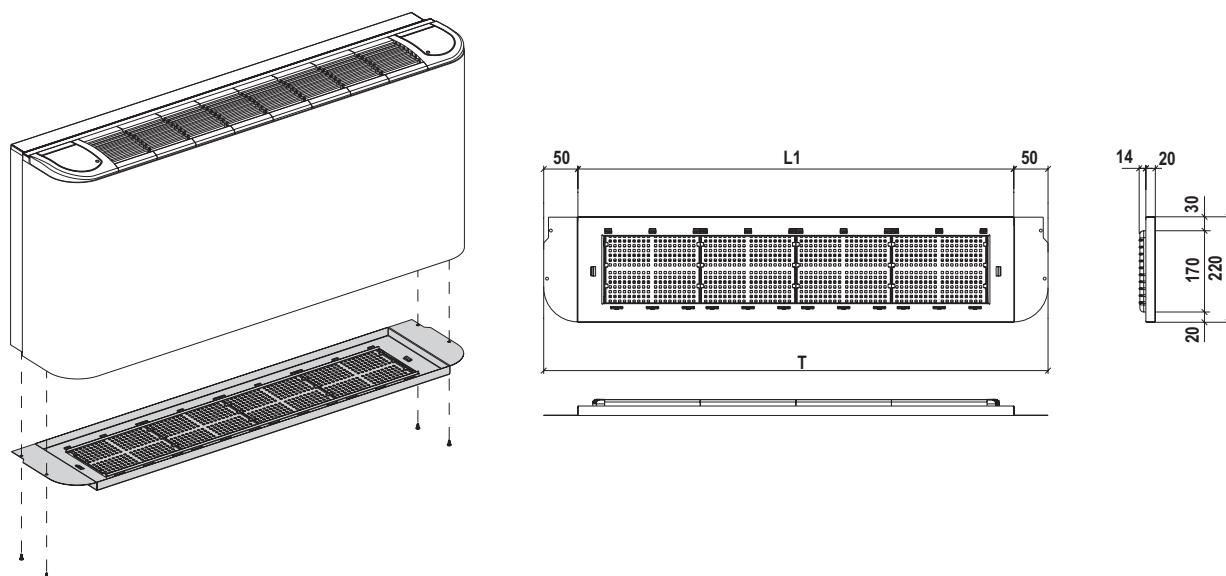

MODEL			WIND10	WIND20	WIND30	WIND40	WIND50	WIND60	WIND70	WIND80	WIND90
	T	mm	655	855	1.055	1.055	1.255	1.255	1.255	1.455	1.455
	L	mm	512	712	912	912	1.112	1.112	1.112	1.312	1.312
	L1	mm	412	612	812	812	1.012	1.012	1.012	1.212	1.212



**Eden takes part in EUROVENT  
CERTIFICATION program.**  
All products are included in  
**EUROVENT DIRECTORY**

All data in this technical manual are no binding for Eden company who takes the right, without advance notice obligation, to provide to any modification for product improvements.