

EAC12 SERIES
AUGUST 12, 1991

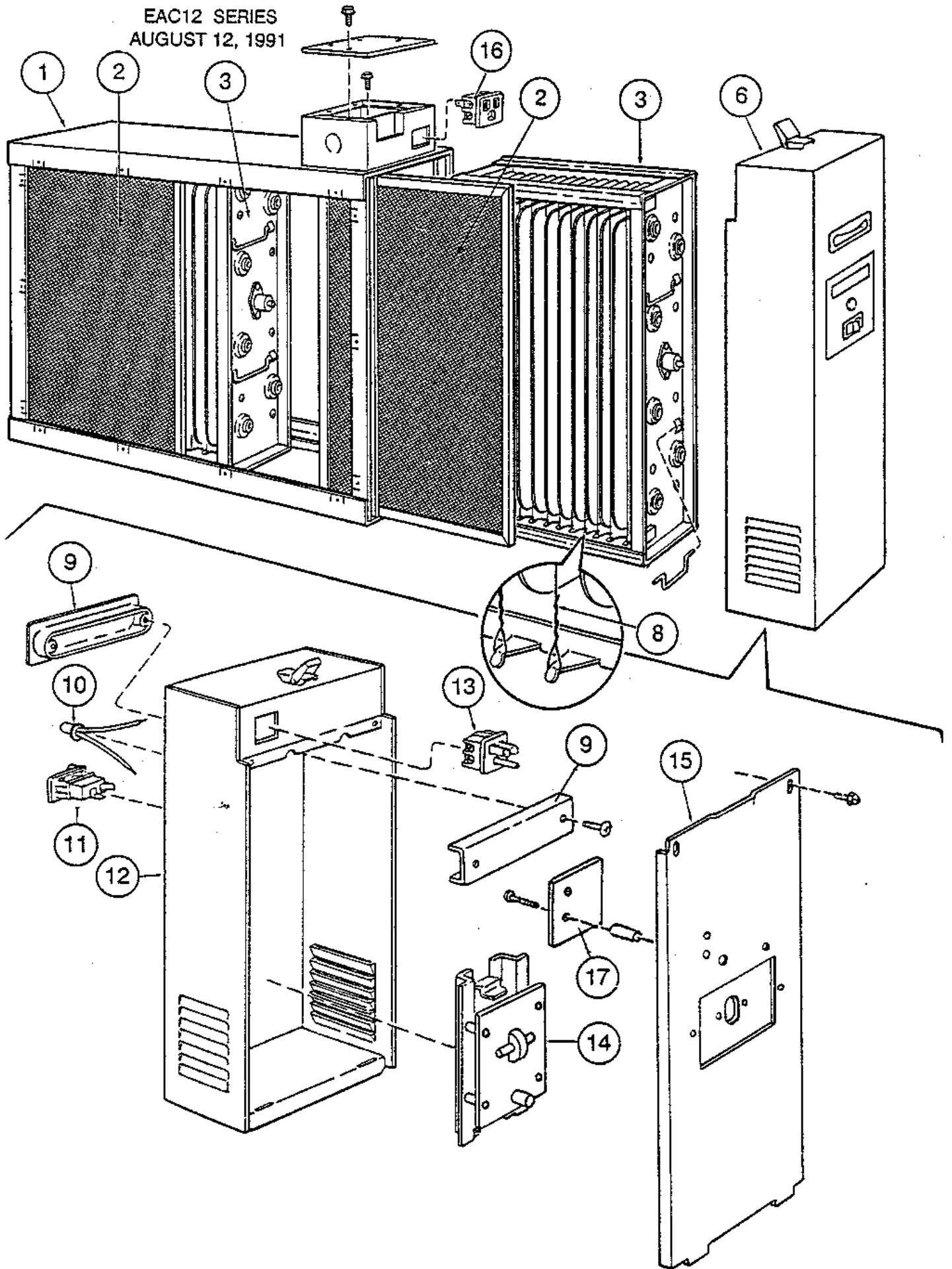

EAC12-20				DASH/Revision # with Qty	
Key	Part Name	Part Number	Description	1	2
Category:PARTS LISTING					
1	WRAPPER	72H0101	CABINET	1	1
10	LIGHT	72H0601	INDICATOR	1	1
11	SWITCH	69H9301	POWER	1	1
12	WRAPPER	72H0701	POWER PACK ONLY	1	1
13	PLUG	69H9501	MALE CONNECTOR	1	1
14	MODULE	69H9601	POWER SUPPLY(FOOTNOTE 1)	1	
14	MODULE	80K6401	POWER SUPPLY		1
15	COVER	72H0801	POWER PACK	1	1
16	PLUG	69H8801	FEMALE CONNECTOR	1	1
17	SWITCH	69H9901	AIR FLOW	1	
17	SWITCH	80K6101	AIR FLOW		1
2	FILTER-AIR	72H0201	WASHABLE	2	2
	FILTER-CHARCOAL	72H0901	H/C F825-046900S2 EAC-2000 CARBON FILTER	2	2
3	CELL-IONIZING	72H0301	H/C F811-031900S2 COLLECTION CELL	2	2
6	POWER PACK	80K6301	H/C F858-10249 POWER PACK ASSY -BEIGE		1
6	POWER-PACK	72H0401	POWER PACK ASSY(nla use 80K63)	1	
8	IONIZING WIRE	72H0501	H/C F843-050000S2 WIRE-IONIZING	12	12
9	HANDLE-DOOR	70H0001	HANDLE	1	1

NOTE

Note1:
WHEN THE 69H9601 POWER SUPPLY MODULE IS REPLACED IN THE FIELD BY
80K6401, THE AIR FLOW SWITCH 69H9901 IN THE UNIT MUST BE REPLACED AT
THE SAME TIME WITH AIR FLOW SWITCH 80K6101.