

1	2	3	4	5	6	7	8									
A	Sigla	Opisania	Primeciani>	Posi?£o	Sigla	Opisania	Primeciani>	Posi?£o	Sigla	Opisania	Primeciani>	Posi?£o				
	AP	RELE DAVLENI' HIGH PRESSURE P-STAT PRESSOSTAT HAUTE PRESSION DRUCKSCHALTER, HOCHDRUCK PRESOSTATO DE ALTA		5/B04	RSF	RELE' SEQUENZA FASE PHASE SEQUENCE CONTROL RELAY RELAIS DE CONTROLE DE SEQUENCE D'ETAGE STEUERRELAIS FUER PHASEFLOGE RELE' CONTROL SECCUENCIA FASES			FS2	PRESSOSTATO FILTRI SPORCHI CLOGGED FILTER PRESSURE SWITCH PRESSOSTAT D'ENCRASSEMENT DE FILTRE DRUCKSCHALTER. FILTERVERSCHMUTZUNG PRESSOSTATO FILTROS SUCIOS		6/A03				
	KA3	RELE' ALTA HI-PRESSURE RELAIS RELAIS HAUTE PRESSION RELAIS HOCHDRUCK RELE DE ALTA		5/E04	SR1	SERRANDA DAMPER REGISTRE MOTORISIERT COMPUERTA		6/C02	R1	RISCALDAMENTO ELETTRICO EL. HEATERS CHAUFFAGE ELETTRIQUE ELETR. HAIZUNG RESISTENCIAS ELETRICAS		3/E05				
	KB	KM1	CONTATTORE COMPRESSORE COMPRESSOR CONTACTOR CONTACTEUR COMPRESSEUR VERDICHTER SCHUETZ CONTACTOR DEL COMPRESSOR		5/E04	FS1	PRESSOSTATO FLUSSO ARIA AIR FLOW PRESSURE SWITCH PRESSOST. D'ENCRASSEMENT DE FILTRE DRUCKSCHALTER NIEDERDRUCK PRESOSTATO DE BAJA		6/A03							
		KM2	CONTATTORE UMIDIFICATORE HUMIDIFIER CONTACTOR CONTACTEUR HUMIDIFICATEUR BEFEUCHTER SCHUETZ CONTACTOR DEL HUMIDIFICADOR			TP1 TP2	TERMOSTATO SICUREZZA RISCALDAMENTO HEATING SAFETY THERMOSTAT THERMOSTAT DE SECURITE' CHAUFFAGE THERMOSTATE ELEKTROHEIZUNG TERMOSTATO DE SEGURIDAD DE LAS RESISTENCIAS		4/B05							
		CM	KM4/5	RISCALDAMENTO ELETTRICO EL. HEATERS CHAUFFAGE ELETTRIQUE ELETR. HAIZUNG RESISTENCIAS ELETRICAS		3/C03	P1	PRESSIONE CONDENSAZIONE CONDENSING PRESSION SENSOR SONDE DU PRESSION DE CONDENSATION KONDENSATIONSDRUCK-FUEHLER SONDA PRESSION CONDENSACION		6/B06						
			C1	KOMPRESSOR COMPRESSOR COMPRESSEUR KOMPRESSOR COMPRESOR			SA	TEMPERATURA AMBIENTE INTERNO SHELTER INTERNAL AIR TEMPERATURE SENSOR SONDE TEMPERATURE D'AIR INTERIOR AUSSENER LUFTEMP.-FILTER SONDA DE TEMPERATURA DE LA DESCARGA DE AIRE		6/B05						
			TR	TRANSFORMADOR TRANSFORMER TRANSFORMATEUR TRANSFORMATOR TRANSFORMADOR		3/C06	SM	TEMPERATURA ARIA IN MANDATA DISCHARGE AIR TEMPERATURE SONDE DE TEMPERATURE ZULUFTTEMMPERATUR TEMP. DE LA DESCARGA DE AIRE		6/B07						
			DS	GLAVN\Y V\KL^CATEL MAIN SWITCH INTERRUPTEUR GENERAL HAUPTSCHALTER INTERRUPTOR GENERAL		3/A02	SE	TEMPERATURA ARIA ESTERNA OUTDOOR AIR SENSOR SONDE D'AIR EXTERNE AUSSENLUFTUEHLER SONDA DE AIRE ESTERNA		6/B08						
			M2	MOTOVENTILATORE EVAPORANTE EVAP. FAN MOTOR MOTEUR VENTILATEUR DE EVAP. EVAP.-LUEFTER MOTOVENTILADOR EVAPORADORA			BP	PRESSOSTATO DI BASSA LOW PRESSURE P-STAT PRESSOSTAT BASSE PRESSION DRUCKSCHALTER NIEDERDRUCK PRESOSTATO DE BAJA								
		M3	MOTOVENTILATORE EVAPORANTE EVAP. FAN MOTOR MOTEUR VENTILATEUR DE EVAP. EVAP.-LUEFTER MOTOVENTILADOR EVAPORADORA		4/E05	A1	REGUL'TOR SKOROSTI SPEED CONTROLLER REGULATEUR DE VITESSE VENTILATOR/DREHZAHLEGLER REGULADOR VELOCIDAD									
		EM	KM3 KM3A	CONTATTORE VENTILATORE FAN MOTOR CONTACTORS CONTACTEUR VENTILATEUR VENTILATOR SCHUETZ CONTACTOR DEL VENTILADOR												
F				DATA	09/09/2004	LENNOX				HF620C0240						
				DISEG.								HF62000240				
				VISTO												
REV.	MODIFICA	DATA	FIRMA	APPR.	SOST. IL:	SOST. DA:	ORIGINE:						FOGLIO 2 DI 16 SEGUE 3			
1	2	3	4	5	6	7	8									

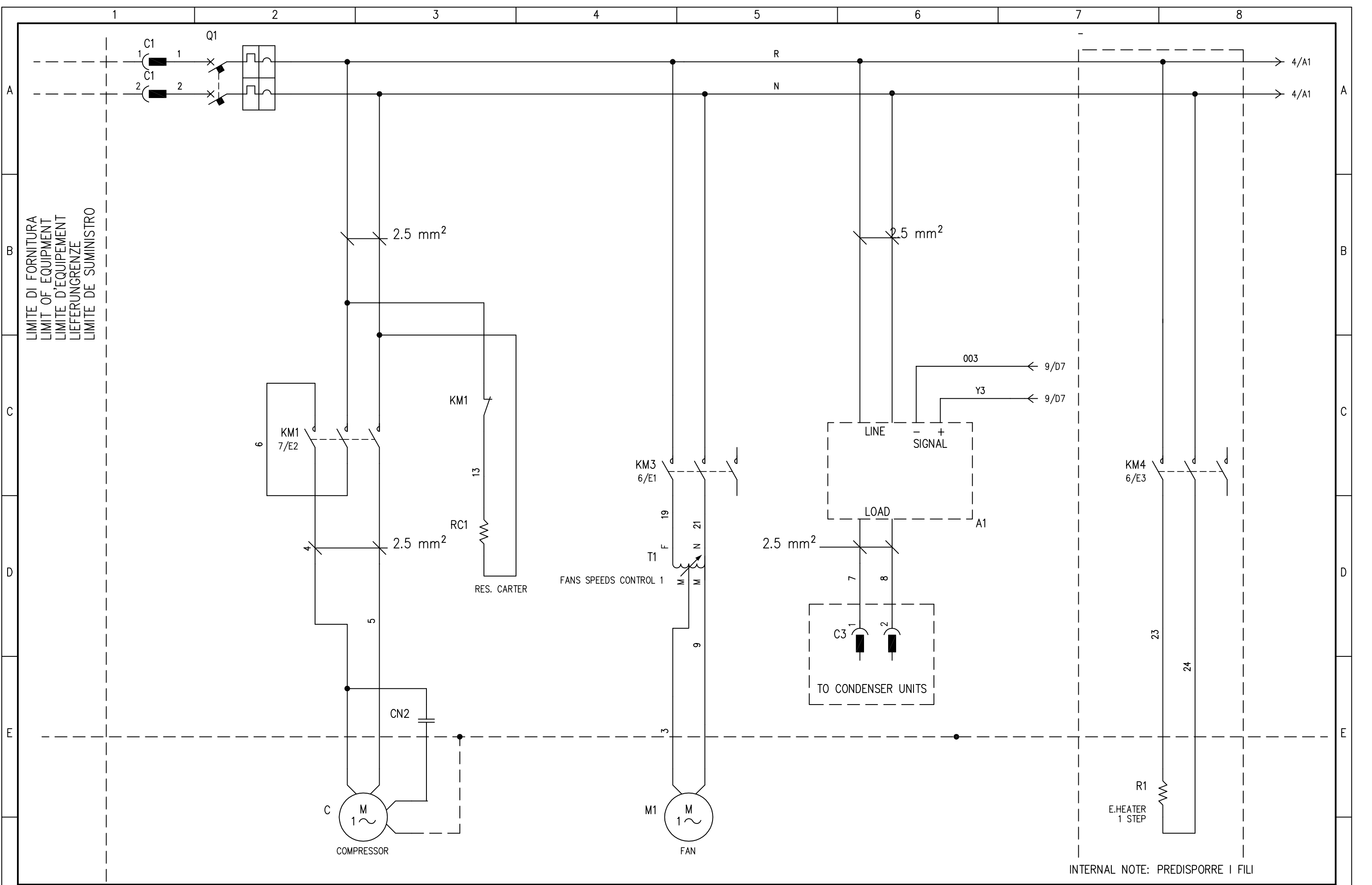

LIMITE DI FORNITURA
 LIMIT OF EQUIPMENT
 LIMITE D'EQUIPEMENT
 LIEFERUNGRENZE
 LIMITE DE SUMINISTRO

INTERNAL NOTE: PREDISPORRE I FILI

		DATA	09/09/2004		LENNOX		HF620C0240			
		DISEG.					HF62000240			
REV.	MODIFICA	DATA	FIRMA	APPR.	SOST. IL:	SOST. DA:	ORIGINE:			FOGLIO 3 DI 16
1		2								SEGUE 4

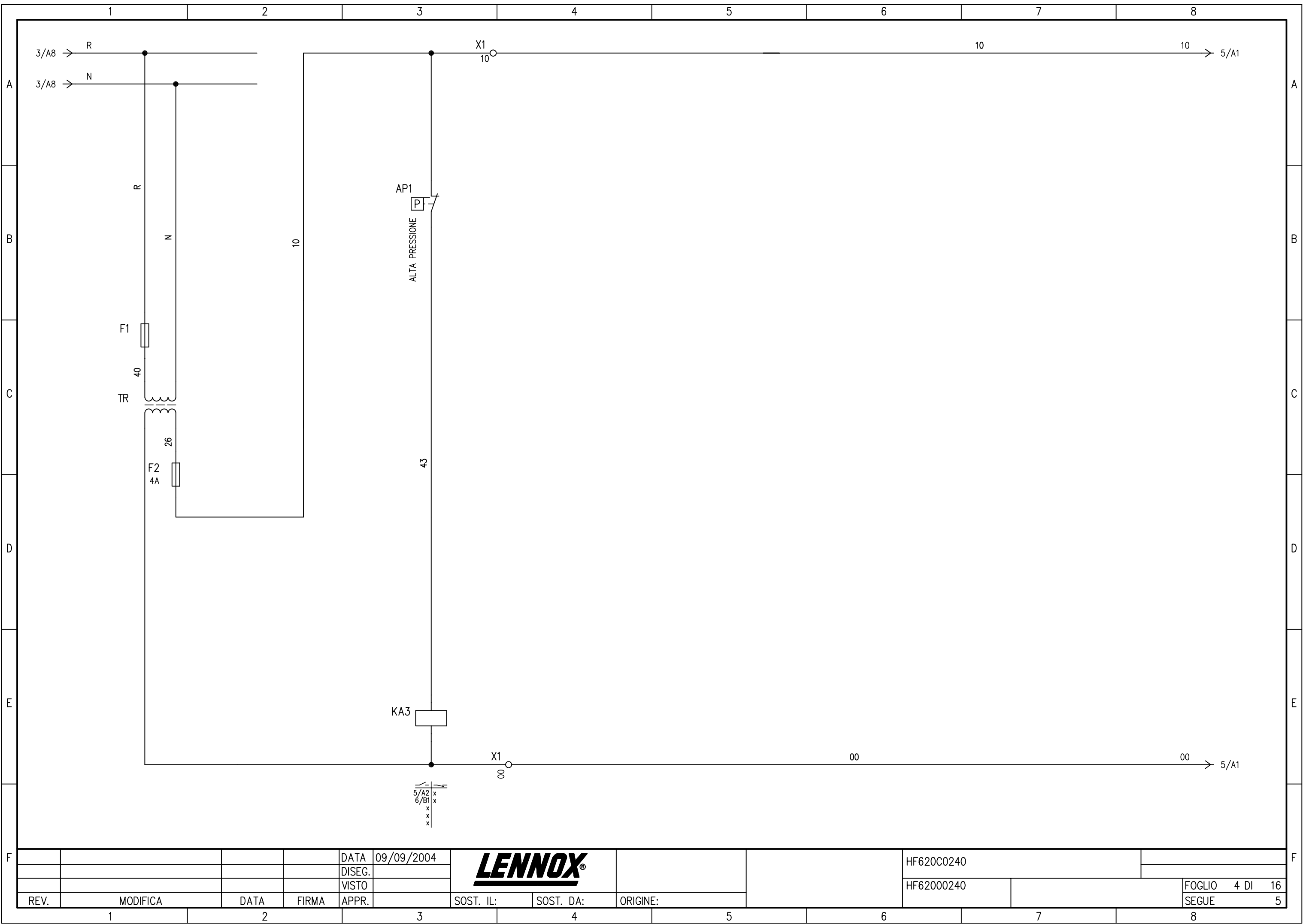

DATA 09/09/2004



HF620C0240

HF62000240

FOGLIO 4 DI 16

SEGUE 5

REV.	MODIFICA	DATA	FIRMA	APPR.

SOST. IL: SOST. DA: ORIGINE:

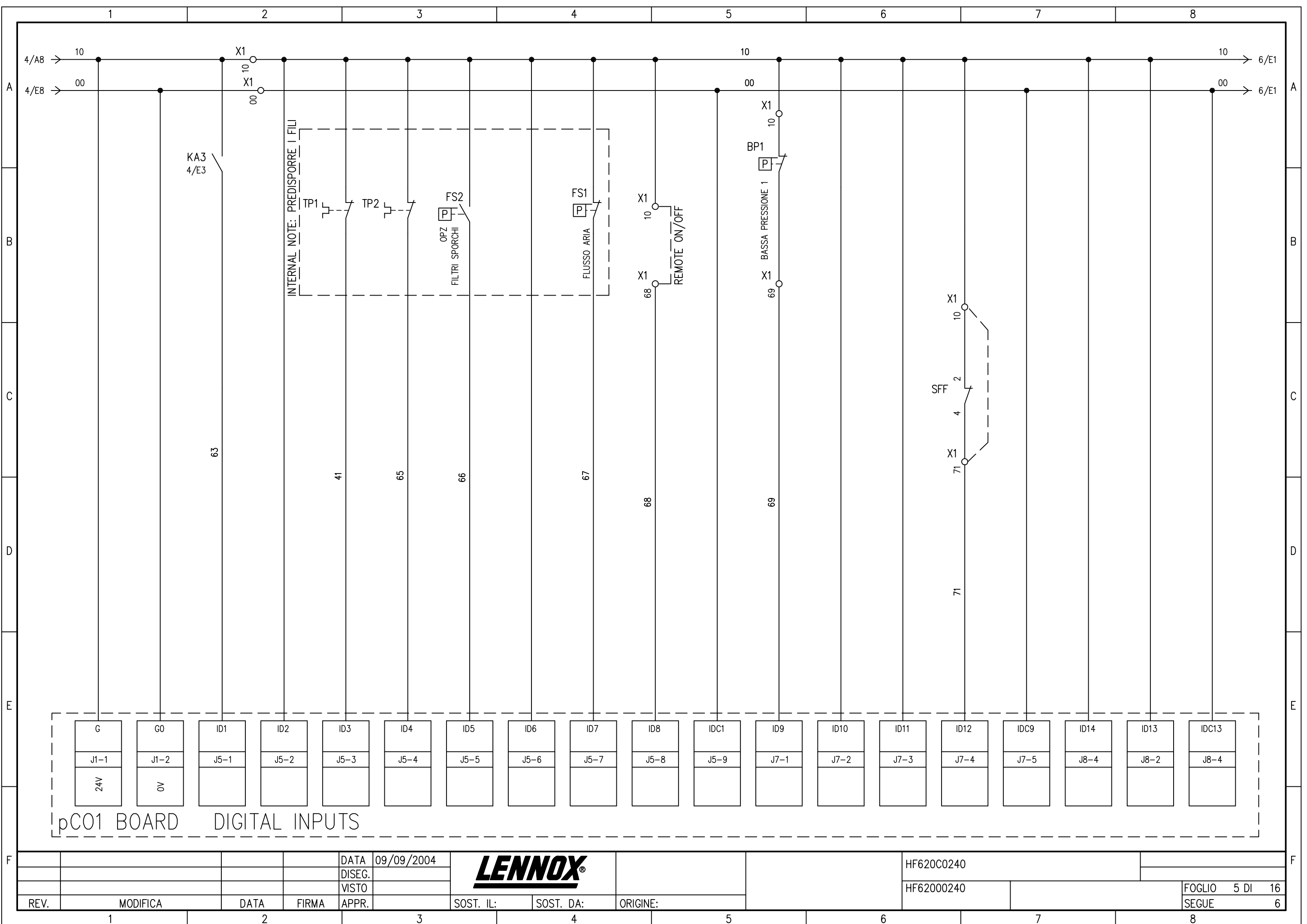

pC01 BOARD DIGITAL INPUTS

G	G0	ID1	ID2	ID3	ID4	ID5	ID6	ID7	ID8	IDC1	ID9	ID10	ID11	ID12	IDC9	ID14	ID13	IDC13
J1-1	J1-2	J5-1	J5-2	J5-3	J5-4	J5-5	J5-6	J5-7	J5-8	J5-9	J7-1	J7-2	J7-3	J7-4	J7-5	J8-4	J8-2	J8-4
24V	0V																	

INTERNAL NOTE: PREDISPORRE I FILI

TP1 TP2

FS2
OPZ
FILTRI SPORCHI

FS1
FLUSSO ARIA

REV.	MODIFICA	DATA	FIRMA	APPR.	SOST. IL:	SOST. DA:	ORIGINE:	HF620C0240	HF62000240	FOGLIO 5 DI 16
1		2			3	4	5	6	7	8
									SEGUE	6



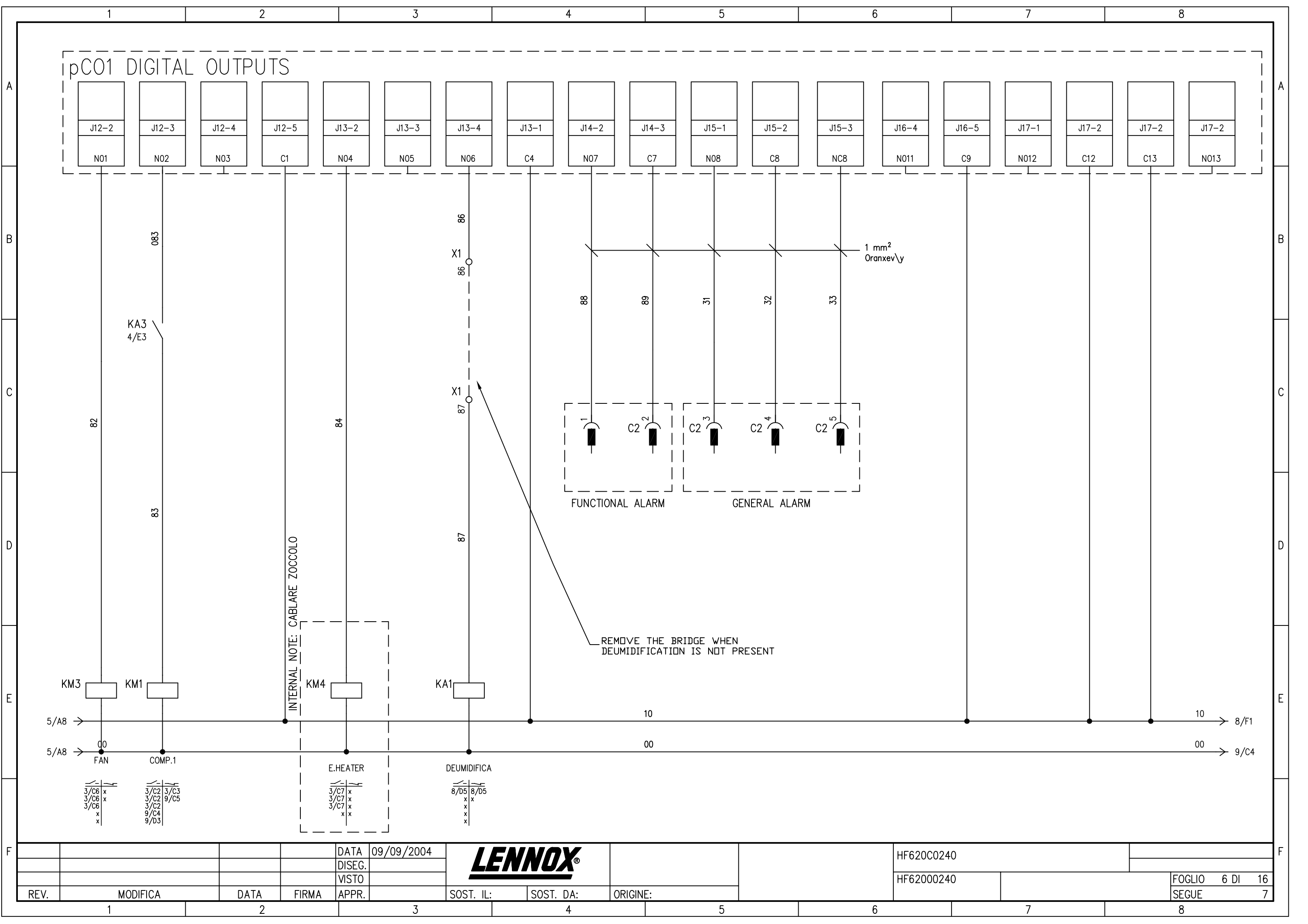

pC01 DIGITAL OUTPUTS

J12-2	J12-3	J12-4	J12-5	J13-2	J13-3	J13-4	J13-1	J14-2	J14-3	J15-1	J15-2	J15-3	J16-4	J16-5	J17-1	J17-2	J17-2	J17-2
N01	N02	N03	C1	N04	N05	N06	C4	N07	C7	N08	C8	NC8	N011	C9	N012	C12	C13	N013

INTERNAL NOTE: CABLARE ZOCCOLO

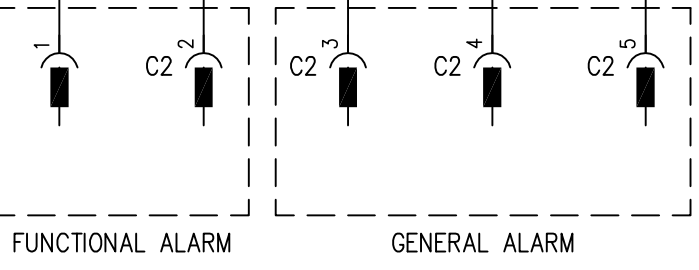

REMOVE THE BRIDGE WHEN DEUMIDIFICATION IS NOT PRESENT

REV.	MODIFICA	DATA	FIRMA	APPR.	SOST. IL:	SOST. DA:	ORIGINE:	HF620C0240	FOGLIO 6 DI 16
1		09/09/2004						HF62000240	SEGUE 7



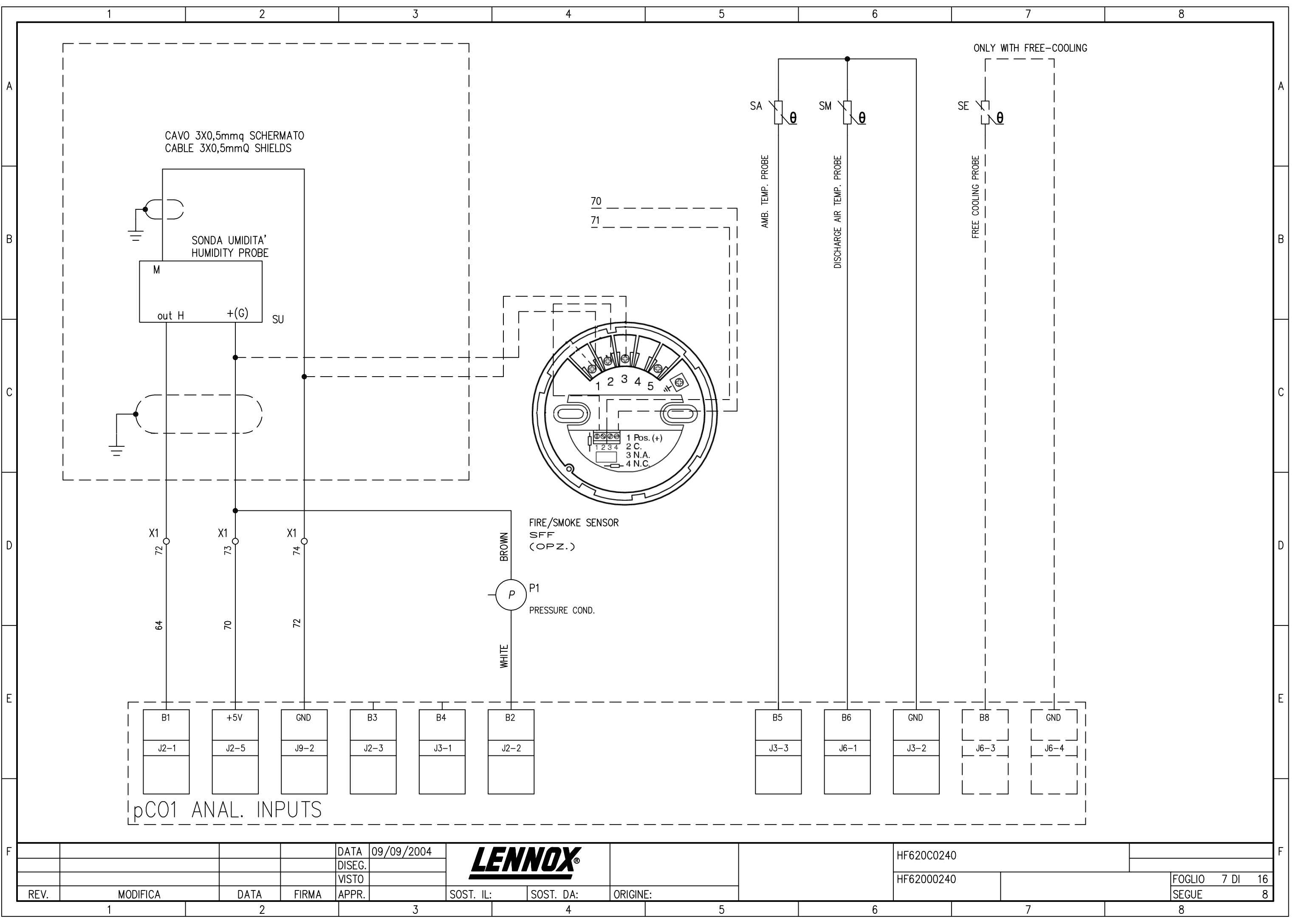

DATA 09/09/2004
 DISEG.
 VISTO
 APPR.



SOST. IL: SOST. DA: ORIGINE:

HF620C0240
 HF62000240

FOGLIO 7 DI 16
 SEGUE 8

REV. MODIFICA DATA FIRMA

1 2 3 4 5 6 7 8

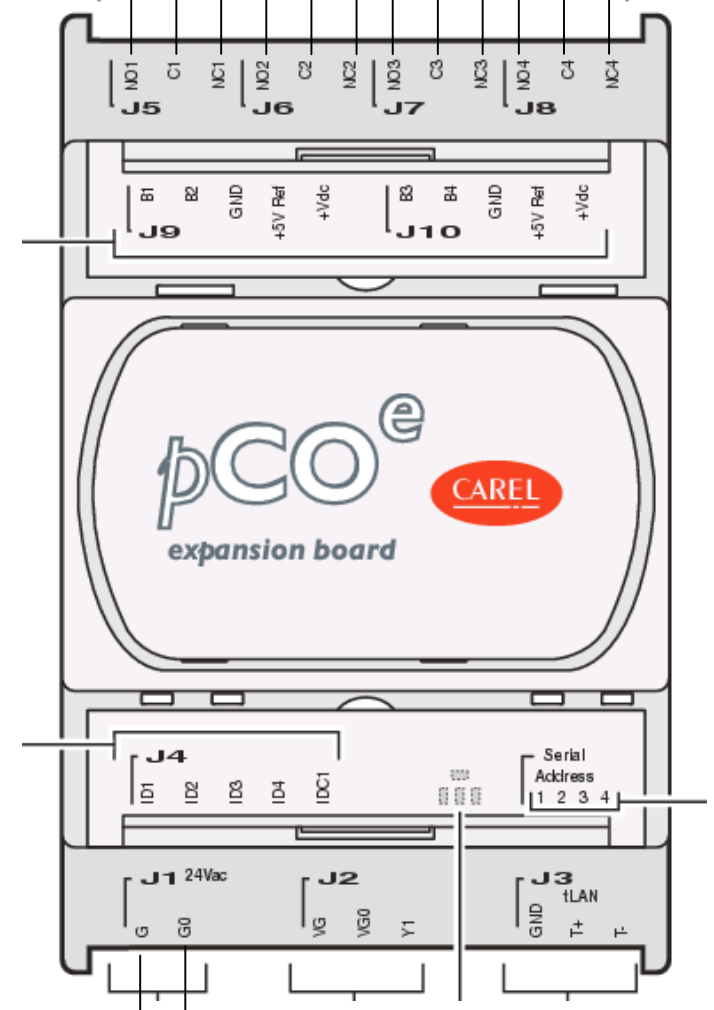
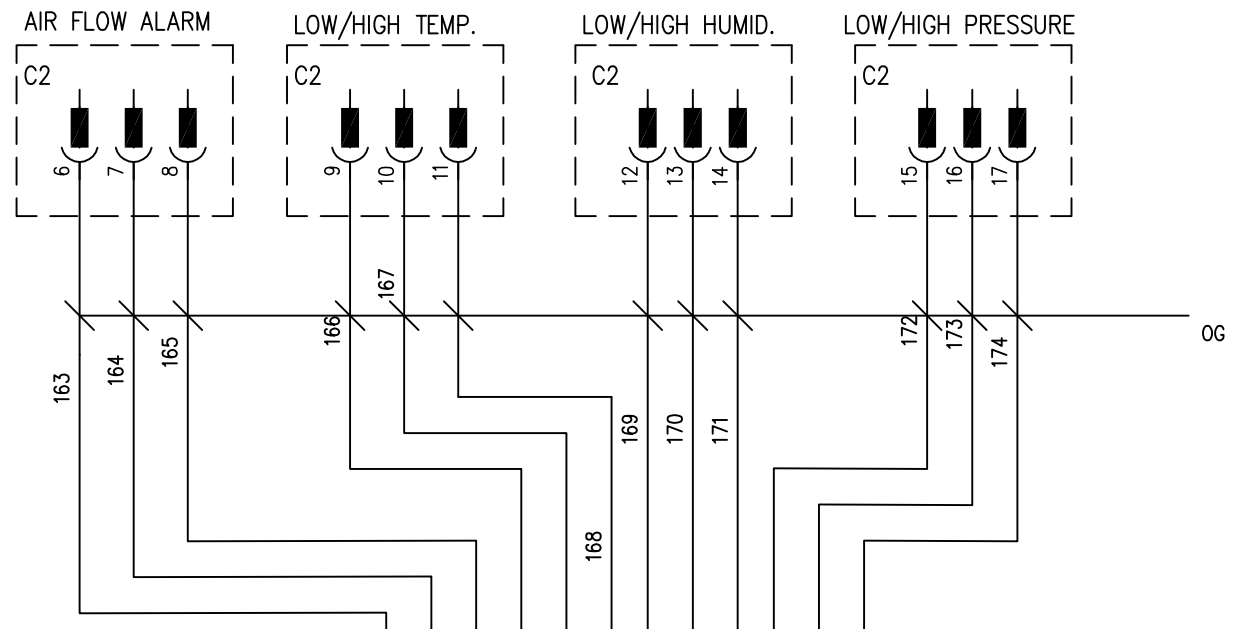

FANS SPEED CONTROL 1

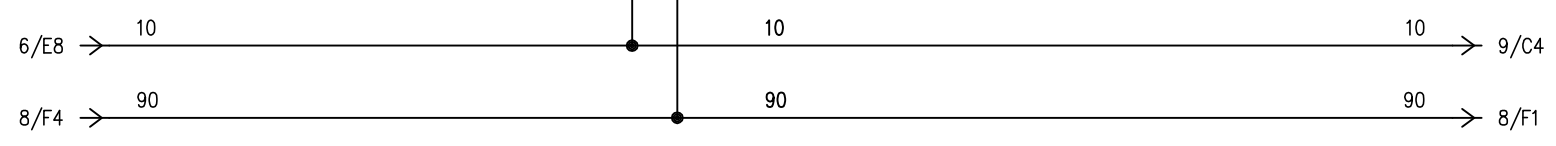
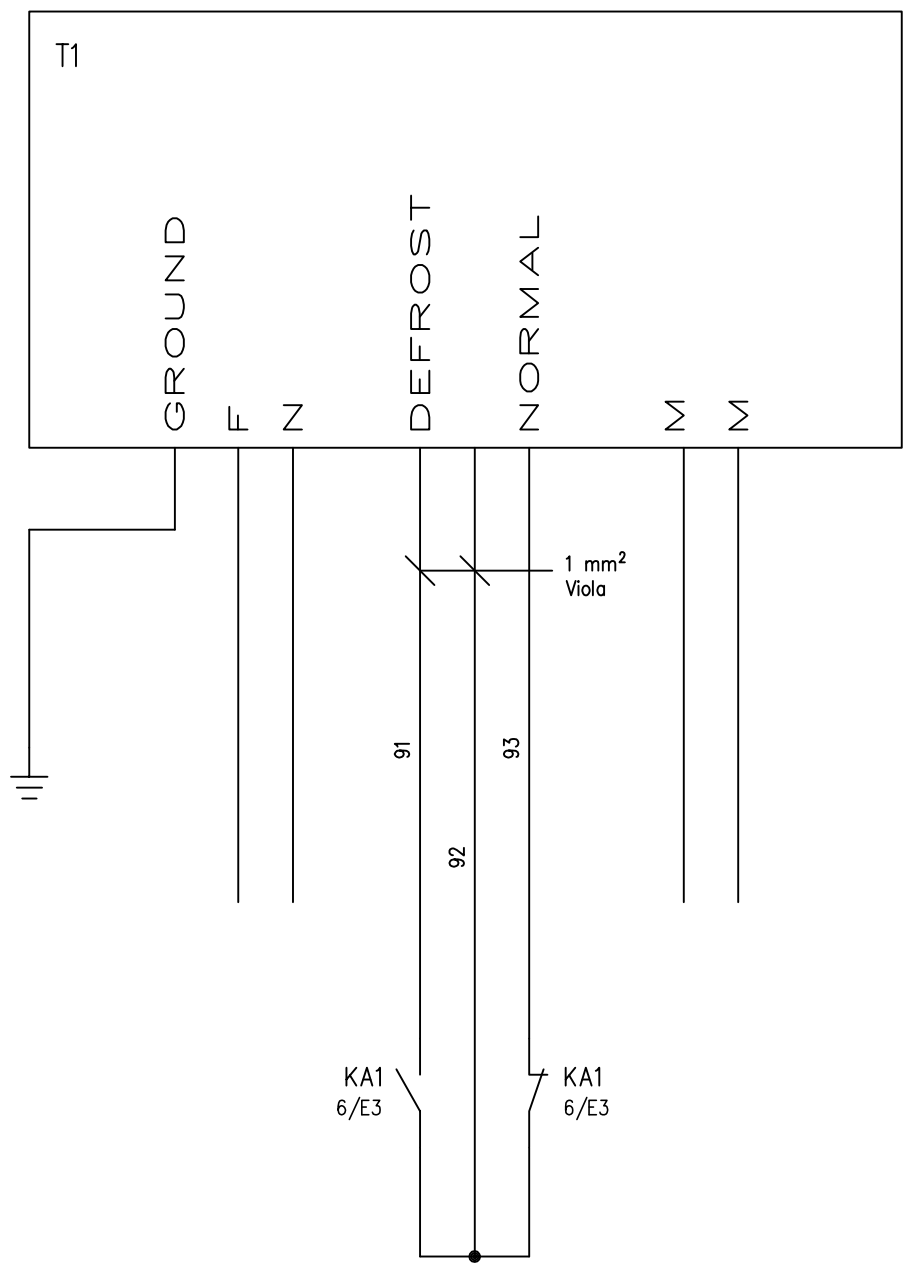

REV.		MODIFICA	DATA	FIRMA	APPR.	SOST. IL:	SOST. DA:	ORIGINE:	HF620C0240	FOGLIO 8 DI 16	
1			09/09/2004						HF62000240	SEGUE 9	
LENNOX											

INTERNAL NOTE: PREDISPORRE I FILI

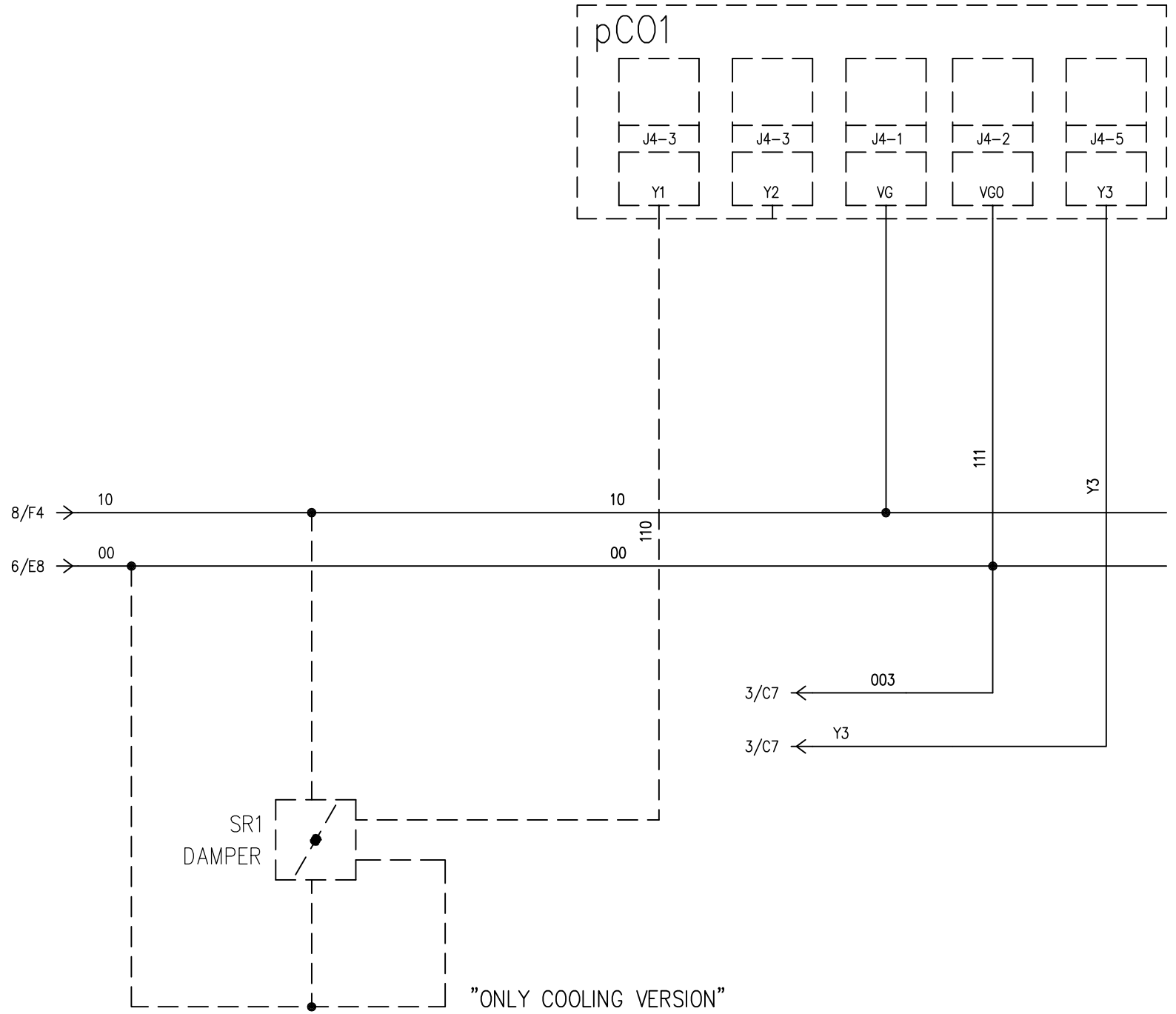
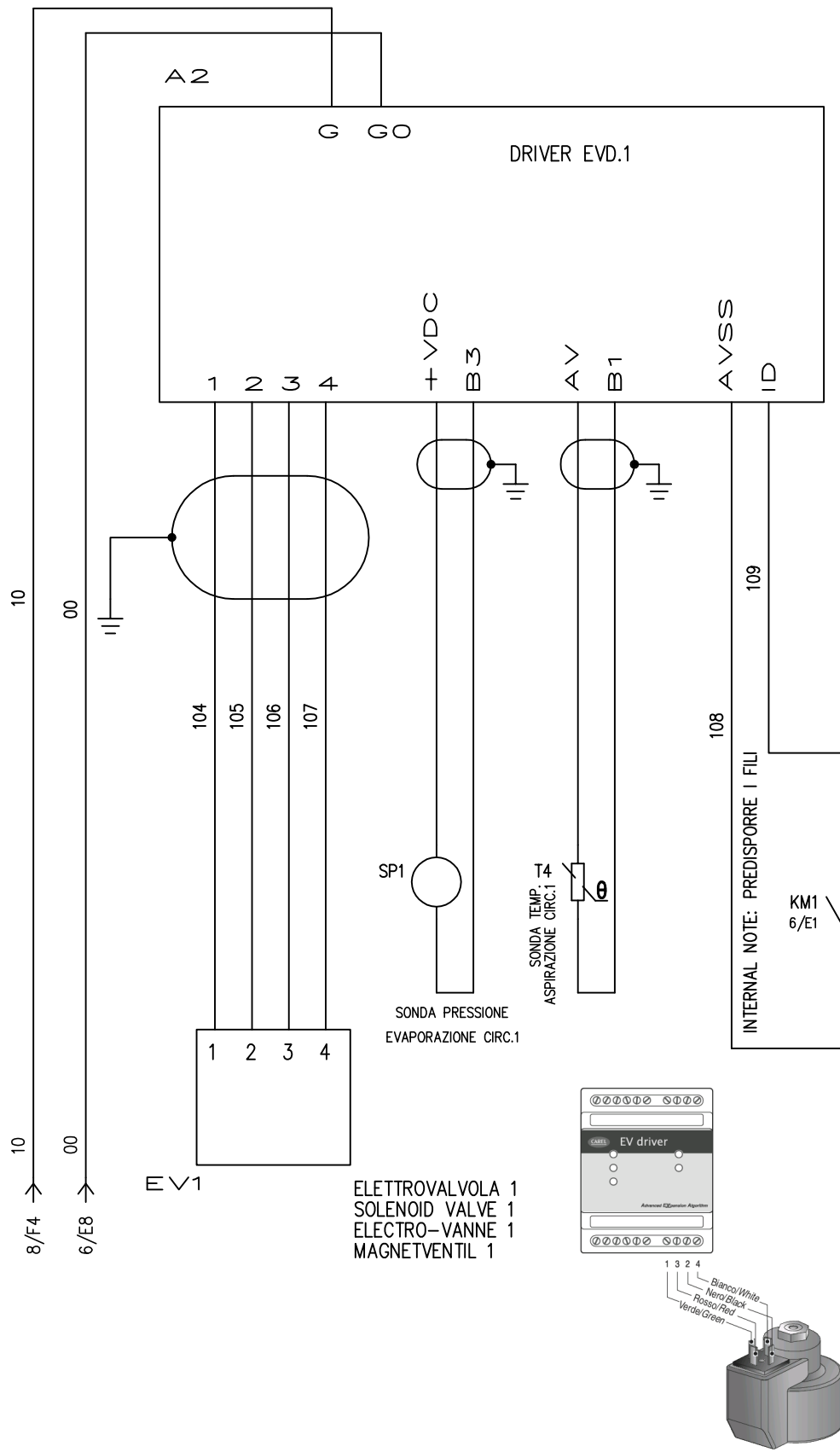

DATA 09/09/2004

LENNOX

HF620C0240

HF62000240

FOGLIO 9 DI 16

SEGUE 10

REV.	MODIFICA	DATA	FIRMA	APPR.
1				

SOST. IL: SOST. DA: ORIGINE:

1

2

3

4

5

6

7

8

TERMINAL STRIP
 BORNIER
 KLEMMLEISTE
 KLEMMLEISTE

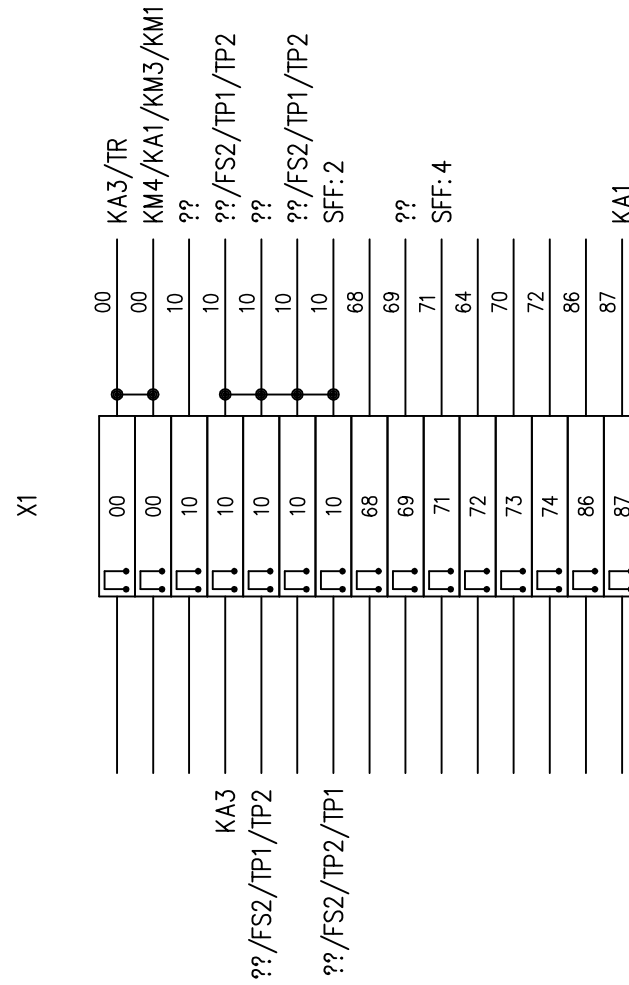

DATA 09/09/2004

DISEG.

VISTO

APPR.



SOST. IL:

SOST. DA:

ORIGINE:

HF620C0240

HF62000240

FOGLIO 10 DI 16

SEGUE 11

REV.

1

2

3

4

5

6

7

8

MODIFICA

DATA

FIRMA

APPR.

SOST. IL:

SOST. DA:

ORIGINE:

HF620C0240

HF62000240

FOGLIO 10 DI 16

SEGUE 11

C1

Pin	Filo	Posizione
1	1	3/A1
2	2	3/A1

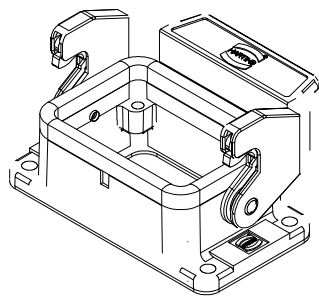
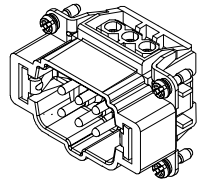
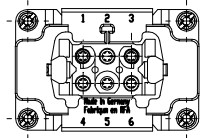

C2

Pin	Filo	Posizione
1	88	6/C4
2	89	6/C5
3	31	6/C5
4	32	6/C5
5	33	6/C6
6	163	8/A1
7	164	8/A1
8	165	8/A2
9	166	8/A2
10	167	8/A2
11	168	8/A2
12	169	8/A3
13	170	8/A3
14	171	8/A3
15	172	8/A4
16	173	8/A4
17	174	8/A4

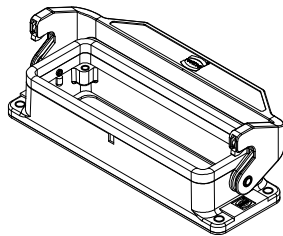
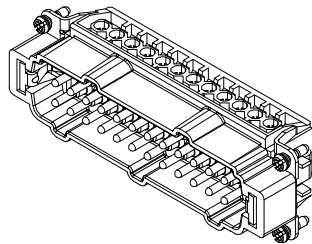
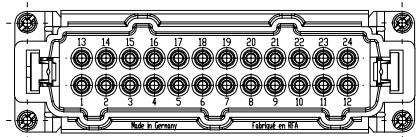

C3

Pin	Filo	Posizione
1	7	3/D6
2	8	3/D6

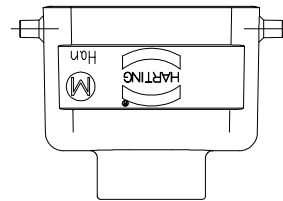
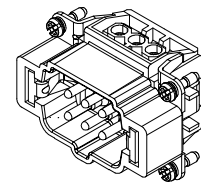
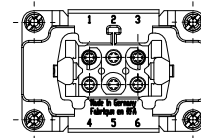

ONLY FOR INTERNAL USE!

DATA 09/09/2004

LENNOX

HF620C0240

HF62000240

FOGLIO 11 DI 16

SEGUE 12

REV.	MODIFICA	DATA	FIRMA	APPR.

SOST. IL: SOST. DA: ORIGINE:

LAYOUT SCHEDA
ELECTRONIC BOARD LAYOUT

CONNETTORI PHOENIX A SPINA COMBICON CON PASSO 5.08 mm. COLORE
VERDE TIPO MSTB 2,5 :

SIG.	POLI	TIPO	CODICE	SIG.	POLI	TIPO	CODICE
J1	2	2,5/2-ST	17 57 01 9	J11	3	2,5/3-ST	17 57 02 2
J2	5	2,5/5-ST	17 57 04 8	J12	5	2,5/5-ST	17 57 04 8
J3	4	2,5/4-ST	17 57 03 5	J13	5	2,5/5-ST	17 57 04 8
J4	6	2,5/6-ST	17 57 05 1	J14	3	2,5/3-ST	17 57 02 2
J5	9	2,5/9-ST	17 57 08 0	J15	3	2,5/3-ST	17 57 02 2
J6	4	2,5/4-ST	17 57 03 5	J16	5	2,5/5-ST	17 57 04 8
J7	5	2,5/5-ST	17 57 04 8	J17	3	2,5/3-ST	17 57 02 2
J8	5	2,5/5-ST	17 57 04 8	J18	3	2,5/3-ST	17 57 02 2
J9	3	2,5/3-ST	17 57 02 2				

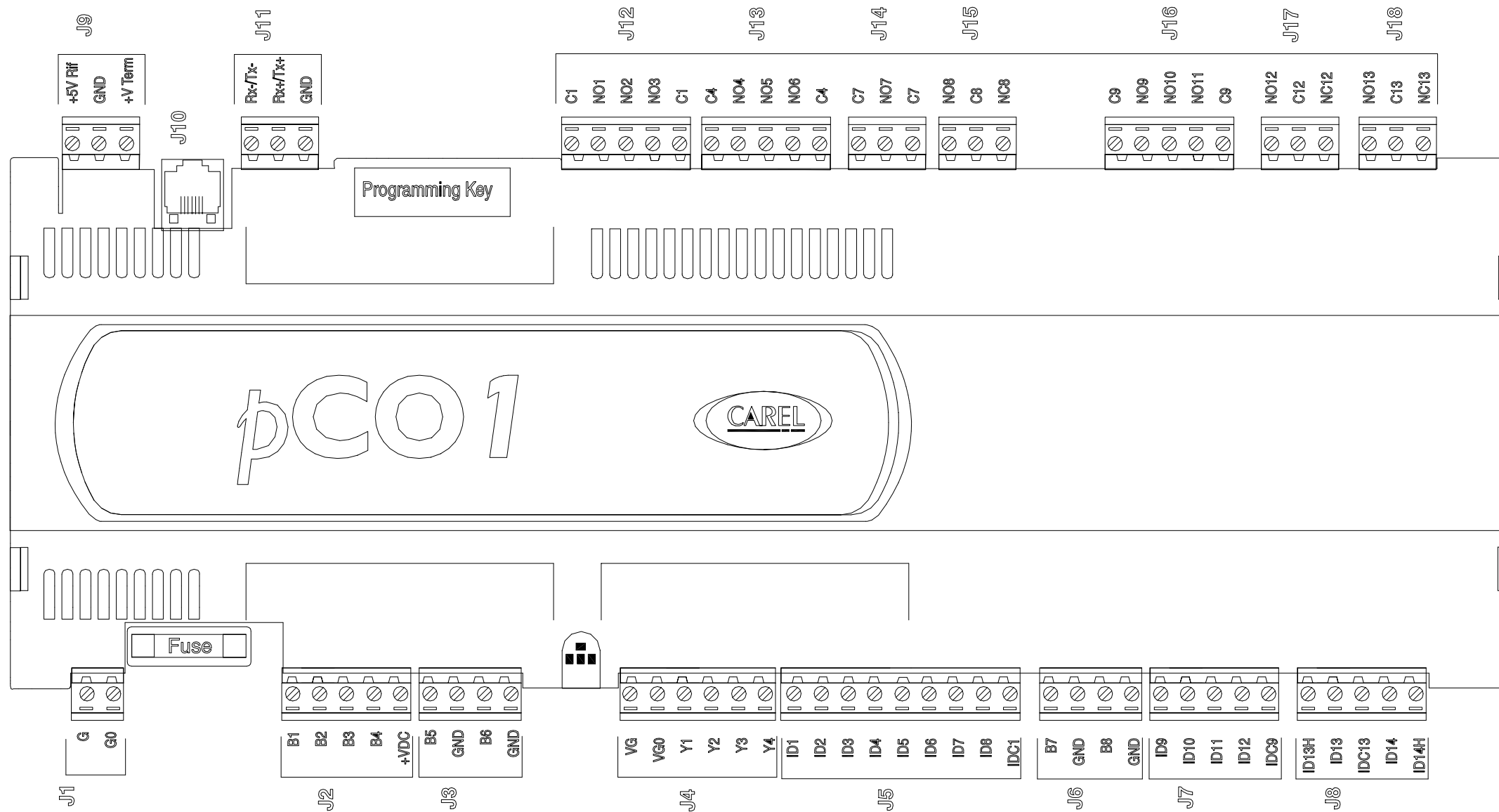

REV.	MODIFICA	DATA	FIRMA	APPR.	SOST. IL:	SOST. DA:	ORIGINE:	HF620C0240	FOGLIO 12 DI 16
1		2			3			HF62000240	SEGUE 13

DATA 09/09/2004
DISEG.
VISTO
LENNOX

CONNECTIONS WITH ALARM OPTION (LEFT SIDE)

C2			
Pin	WIRE N°	POS.	
Pin	Filo	Posizione	
1	88	6/C4 C	FUNCTIONAL ALARM
2	89	6/C5 N.O.	
3	31	6/C5 N.O.	GENERAL ALARM
4	32	6/C5 C	
5	33	6/C6 N.C.	AIR FLOW ALARM
6	163	8/A1 N.O.	
7	164	8/A1 C	LOW/HIGH TEMP.
8	165	8/A2 NC	
9	166	8/A2 N.O.	LOW/HIGH UMIDITY
10	167	8/A2 C	
11	168	8/A2 N.C.	LOW/HIGH PRESSURE
12	169	8/A3 N.O.	
13	170	8/A3 C	
14	171	8/A3 N.C.	
15	172	8/A4 N.O.	
16	173	8/A4 C	
17	174	8/A4 N.C.	

CABLE SECTION 0.75mmq (MAX)

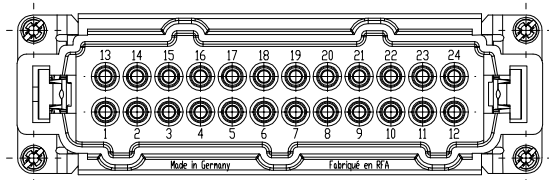

24 POLE FEMALE CONN.

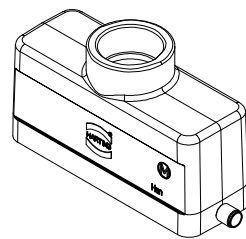
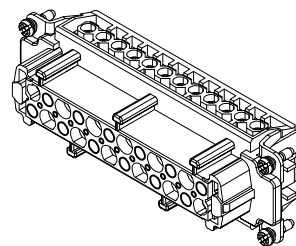

CONNECTIONS STD. ALARM (LEFT SIDE)

C2			
Pin	WIRE N°	POS.	
Pin	Filo	Posizione	
1	88	6/C4 C	FUNCTIONAL ALARM
2	89	6/C5 N.O.	
3	31	6/C5 N.O.	GENERAL ALARM
4	32	6/C5 C	
5	33	6/C6 N.C.	
6			
7			
8			
9			
10			
11			
12			
13			
14			
15			
16			
17			

CABLE SECTION 0.75mmq (MAX)

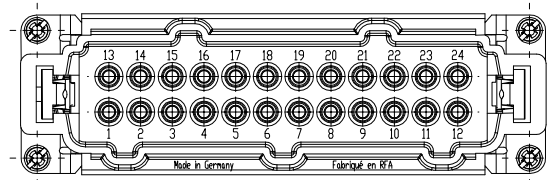

24 POLE FEMALE CONN.

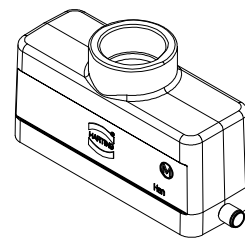
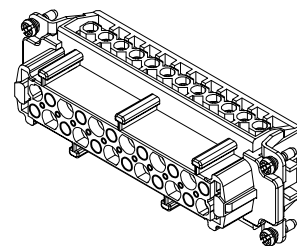

POWER SUPPLY CONNECTIONS (LEFT SIDE)

C1			
Pin	WIRE N°	POS.	
Pin	Filo	Posizione	
1	1	3/A1	
2	2	3/A1	

CABLE SECTION 2.5mmq

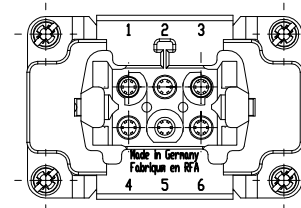

6 POLE FEMALE CONN.

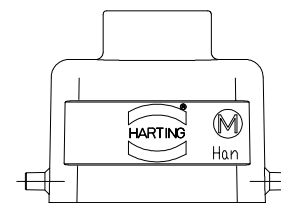
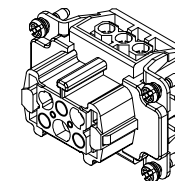

CONDENSER UNIT POWER S. CONNECTIONS (RIGHT SIDE)

C3			
Pin	WIRE N°	POS.	
Pin	Filo	Posizione	
1	7	3/D6	
2	8	3/D6	

CABLE SECTION 2.5mmq

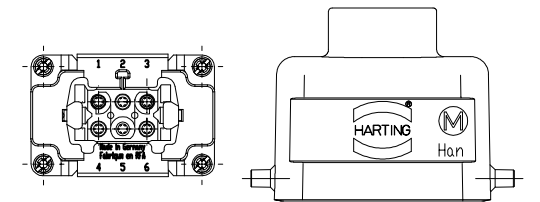

6 POLE MALE CONN.

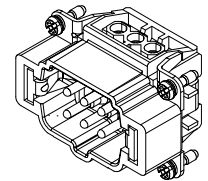

6 POLE FEMALE CONN.

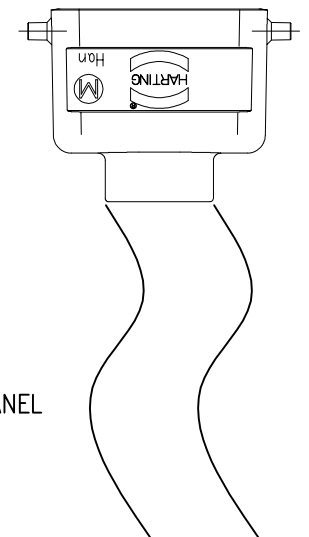
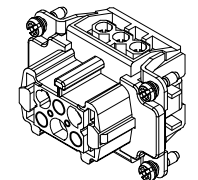

CABLE FROM E.PANEL

DATA 09/09/2004

DISEG.

VISTO

APPR.

LENNOX

SOST. IL:

SOST. DA:

ORIGINE:

HF620C0240

HF62000240

HF620D0240

FOGLIO 13 DI 16

SEGUE 14

REV.

1

2

3

4

5

6

7

8

LAYOUT

PIASTRA DI FONDO HF17001795 REV.A

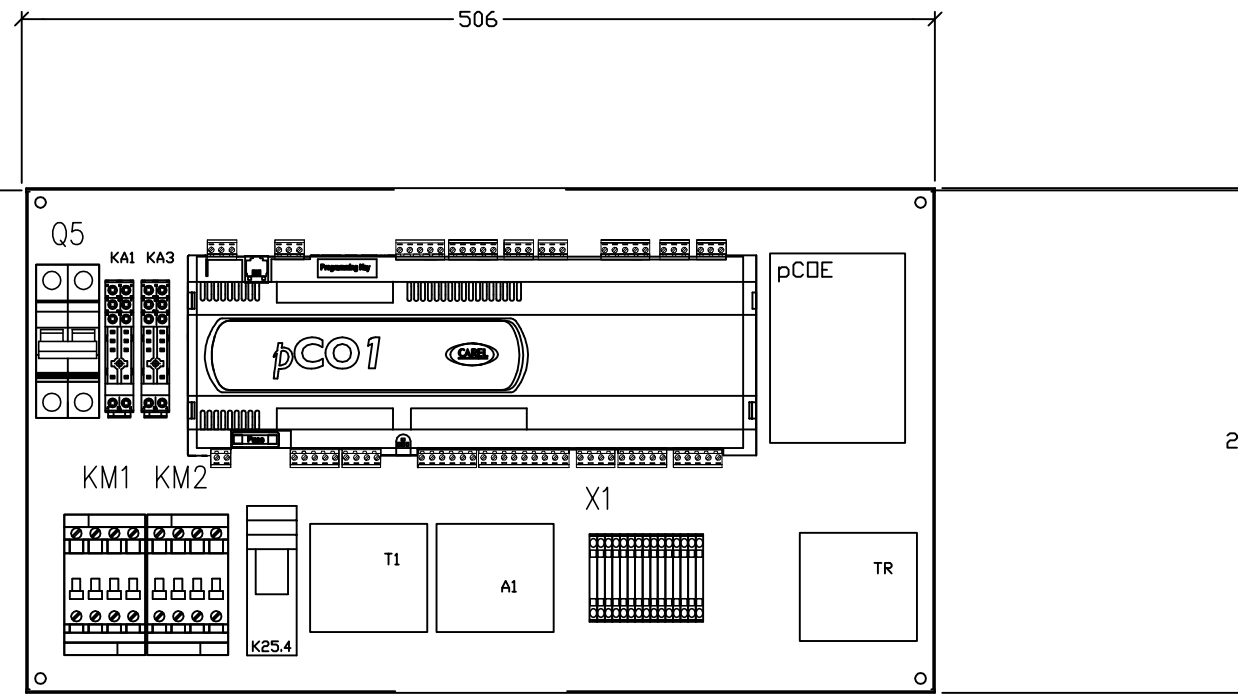

C1 CAVO NPI 3X2,5mmq L=850mm
SPELLATURA FINE CAVO 100mm PUNTALINI

C2 FILI ROSSI IN GUAINA TRECCIATA L=850mm
SPELLATURA FINE CAVO 100mm PUNTALINI

SR1 FILI ROSSI IN GUAINA TRECCIATA L=550mm
SPELLATURA FINE CAVO 100mm PUNTALINI

CAVO NPI 3X2,5mmq L=850mm
SPELLATURA FINE CAVO 100mm PUNTALINI C3

M1 CAVO NPI 3X1,5mmq L=500mm
SPELLATURA FINE CAVO 100mm PUNTALINI

CAVO NPI 3X2,5mmq L=1250mm
SPELLATURA FINE CAVO 100mm C

CAVO NPI 2X1mmq L=1250mm
SPELLATURA FINE CAVO 100mm AP

PLANIMETRIA DA VEDERE INSIEME

DATA 09/09/2004

DISEG.

VISTO

APPR.

LENNOX

SOST. IL:

SOST. DA:

ORIGINE:

HF620C0240

HF62000240

FOGLIO 14 DI 16

SEGUE 15

REV.

1

2

3

4

5

6

7

8

1	2		3	4	5	6	7	8	
060/080	Ref-mark	Function	Technical data	Item code	Description	Amount	M.U.	Position	
	AP1	ALTA PRESSIONE				1		4/C02	
	BP	BASSA PRESS.				1		5/A06	
	C1	COMPRESSORE				1		3/E02	
	EV1					1		7/B05	
	EV2					1		7/B05	
	F1/F2		4AF		FUSIBILE 5X20	1	PCE	3/D08	
	KA1	RELE' DEUM.		40528024		1		4/E02	
	KA3	RELE' ALTA PRESSIONE		40528024		1		4/E02	
	KM1	COMP.		LS410-55/51596	TEL .AEG LS4.10 24V/DILEEM-10	1	PCE	4/E04	
	KM3	VENT. EVAP.		LS410-55/51596	TEL. AEG LS4.10 24V/DILEEM-10	1	PCE	4/E07	
	KM4	RISC. 1 STEP		55348024		1	PCE	6/B03	
				DATA 09/09/2004	LENNOX®	HF620C0240			
				DISEG.		HF62000240			
REV.	MODIFICA	DATA	FIRMA	APPR.	SOST. IL:	SOST. DA:	ORIGINE:	FOGLIO 15 DI 16 SEGUE 16	
1	2	3	4	5	6	7	8		

1	2	3	4	5	6	7	8	
060-080	Ref-mark	Function	Technical data	Item code	Description	Amount	M.U.	Position
A	M1	VENT. EVAP.				1		3/E05
	Q2	COMPRESSORE		E92C25/242882	INT.AUT.Elfa E90 2P C 25A 6kA /PLS6-C25/2	1	PCE	3/B04
	R1	RISCALDAMENTO ELETTRIC.				1		3/E04
B	SA	SONDA AMBIENTE				1		6/B05
	TR2		100VA		CON FUS. A BORDO	1		3/C07



DATA	09/09/2004	LENNOX®			HF620C0240		
DISEG.					HF62000240		
VISTO							
REV.	MODIFICA	DATA	FIRMA	APPR.	SOST. IL:	SOST. DA:	ORIGINE:
1		2			3	4	5
							6
							7
							8